

INDUSTRIAL HOSES AND FITTINGS

THE CORRECT COMBINATION IS CRUCIAL

We respond to all complex and diverse types of use with diverse hoses in different versions. From the simple water hose to maximum pressure hoses to special designs such as heatable 2-component hoses – our product range is diverse and comprehensive. The hoses consist of different materials depending on the application: because different types of hoses such as oil and fuel hoses, foodstuff hoses or multi-purpose hoses require different rubber mixtures, joints and fittings.

IMPORTANT:

The information shown in this chapter corresponds to the current state of the art, represents the result of many years of tests and trials or is based on resistance specifications of the media shown. Please note that general resistance specifications cannot include all media and temperatures and are dependent on diverse influences. The individual operating conditions influence the usual use so that these can only provide the reliability which you can expect according to the written product information. In the case of doubt, the specifications must be checked for the individual use. No liability can be accepted in the case of improper use such as crushing, tearing, pulling or loading with unauthorised media.

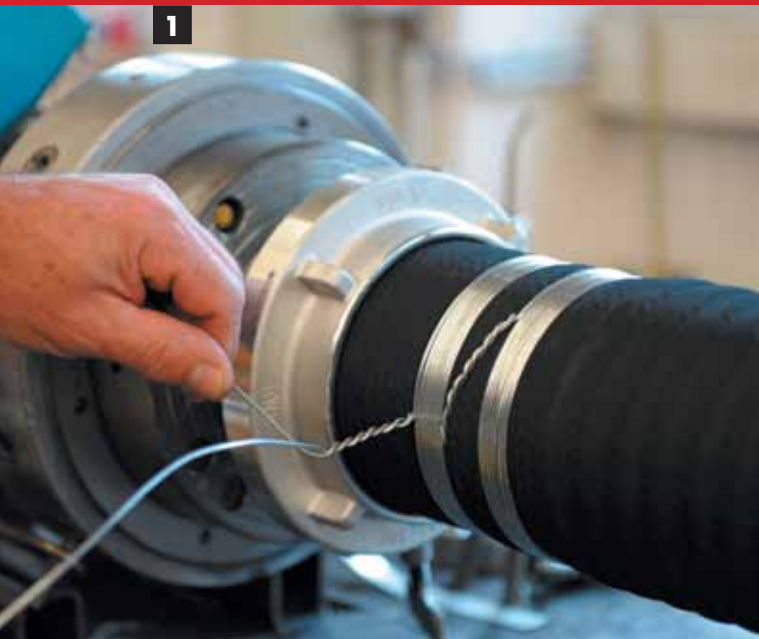

- 1** A hose profile at the factory: Assembly of a suction hose with Storz coupling and wire binding.
- 2** Hose binding which makes the firm connection between hose and fitting.

MANUFACTURE AND MACHINING

PERFECT COMBINATION, PERFECT FURTHER PROCESSING

Whether locally or by telephone – we advise you personally, define your requirements jointly with you and support you from the product selection to the individual further processing to the assembly.

All-round Service

We not only support you for the selection of the optimum hose/fitting combination but we also machine and refine the selected products for you. Cutting to length accurate to the millimetre is included in our services as well as the compilation of complex hose packages and complete hose systems.

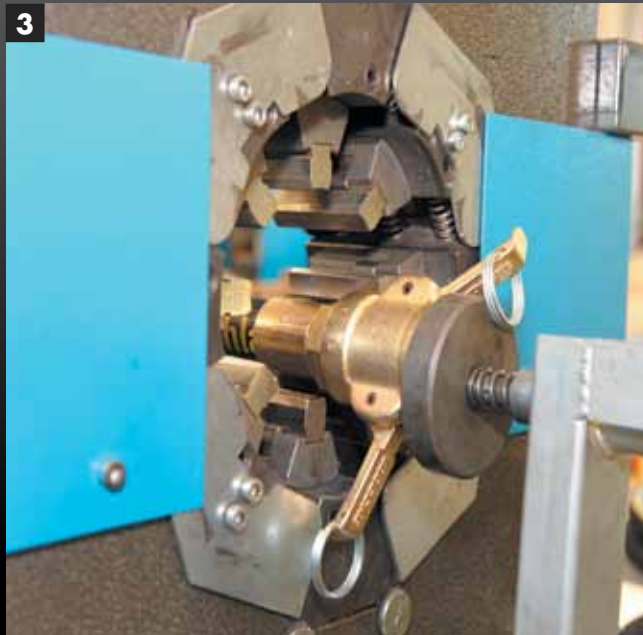

3 Complete lines are our strength: Pressing of an industrial hose line with mortar hose fitting.

PRODUCT RANGE ON THE NEXT PAGES

Industrial Hoses

- Suction, blower and delivery hoses
- Exhaust gas hoses
- Suction, blower and delivery hoses, hose clamps, -connection parts, -couplings, -connectors
- Plastic spiral hoses
- Chemical hoses
- Steam hoses
- Flat hoses
- Delivery hoses
- Delivery hose systems
- Gas hoses
- Compensators and corrugated hoses
- Foodstuff hoses
- Air hoses
- Oil and fuel hoses
- Hoses without lining
- Multi-purpose hoses
- Water hoses
- Hose bracket systems

EXHAUST, VENTILATION AND CONVEYOR HOSES

AIRDUC® PVC 345 – heavy-duty design



Exhaust and conveyor hose

- for solids such as powder, chippings and granulates
- for gaseous and liquid media
- for dust removal and vacuum systems, air conditioning
- as a robust protective hose
- smooth interior
- optimum flow design
- flexible at low weight
- increased pressure and vacuum strength
- good resistance against acids and bases
- good chemical resistance
- good UV and ozone resistance
- minimal bending radii
- kink-proof
- gas-tight and liquid-tight
- non-flammable according to UL94-HB
- conductive (according to BGR 132, formerly ZH 1/200) for grounding of coils

Area of application: Exhaust/conveyor hose

Design: Heavy design

Reinforcement: Steel wire spirals

Material: PVC

Length: 10 m

Temperature range: ca. -20 °C to ca. +70 °C

Colour: grey

Item No.	Inner diameter mm	Material thickness mm	Outer diameter mm	Operating pressure bar / 20 °C	Vacuum bar / 20 °C	Bending radius mm
497660	20	1.5	28	2.05	0.95	28
192040	25	1.5	33	1.73	0.93	33
192050	30	1.5	40	1.70	0.91	40
497670	32	1.5	42	1.69	0.90	42
497680	35	1.5	45	1.55	0.90	45
497690	38	1.5	48	1.44	0.89	48
192060	40	1.5	50	1.37	0.87	50
497700	42	1.5	52	1.31	0.86	52
192070	50	1.5	60	1.26	0.84	60
192080	60	1.5	70	1.05	0.70	70
497730	65	1.5	75	0.98	0.62	75
192090	70	1.5	82	0.91	0.56	98
192100	75	1.5	87	0.85	0.51	104
192110	80	1.5	92	0.80	0.48	110
192120	90	1.5	102	0.71	0.40	122
192130	100	1.5	112	0.64	0.33	134
497740	105	1.5	117	0.61	0.32	140
192140	110	1.5	122	0.59	0.30	146
497750	115	1.5	127	0.56	0.28	152
192150	120	1.5	132	0.54	0.27	158
459710	125	1.5	137	0.52	0.26	164
192160	130	1.5	142	0.50	0.24	170
192170	140	1.5	152	0.46	0.22	182
192180	150	1.5	162	0.43	0.19	194
192190	160	1.5	172	0.40	0.17	206
192210	180	1.5	192	0.36	0.13	230
192220	200	1.5	213	0.32	0.09	256
192240	250	1.5	263	0.26	0.06	316
192260	300	1.5	313	0.22	0.05	376

EXHAUST, VENTILATION AND CONVEYOR HOSES



PROTAPE® PUR 330 MHF – super-lightweight design

Suction and blower hose

- for abrasive solids such as dusts, powders, fibres and chippings
- for gaseous media
- for dust-removal and vacuum systems
- for lawnmowers and leaf vacuums
- for food, pharma and chemical industries
- high flexibility and collapsible at a 3:1 ratio
- wear-resistant
- flow-optimised
- high tensile and tear strength
- Walls are food-compatible according to FDA 21 CFR 177.2600 and 178.2010, EC Guideline 2002/72/EC, including the most recent amended Guideline 2007/19/EC, German Recommendation XXXIX BfR polyurethane
- Permitting according to EC Guideline 2002/72/EC, including the most recent amended guideline 2007/19/EC by an independent testing institute for the entire hose
- odour-free and tasteless
- resistant to microbes and hydrolysis
- good oil and petroleum resistance
- good chemical resistance
- good UV and ozone resistance
- very good flexibility in cold
- minimal bending radii
- kink-proof
- free of plasticisers and halogens
- gas-tight and liquid-tight
- conductive (according to BGR 132, formerly ZH 1/200) for grounding of coils

Area of application: Exhaust/blower hose
Design: super-light design
Reinforcement: Steel wire spirals
Material: Ether PUR
Length: 10 m
Temperature range: ca. -40 °C to ca. +90 °C
Colour: Natural-transparent



Item No.	Inner diameter mm	Material thickness mm	Outer diameter mm	Operating pressure bar / 20 °C	Vacuum bar / 20 °C	Bending radius mm
10022336	32	0.6	39	1.26	0.34	39
4330900	60	0.6	68	0.68	0.21	68
4330910	65	0.6	73	0.63	0.18	73
4330920	70	0.6	78	0.58	0.15	78
4330930	75	0.6	83	0.54	0.14	83
4330940	80	0.6	88	0.51	0.13	88
4330950	100	0.6	108	0.41	0.09	108
4330960	110	0.6	118	0.37	0.08	118
4330970	120	0.6	128	0.34	0.07	128
4330980	125	0.6	133	0.33	0.06	133
4330990	140	0.6	148	0.29	0.06	148
4331000	150	0.6	158	0.27	0.05	158
4331010	160	0.6	168	0.25	0.05	168
4331020	180	0.6	188	0.23	0.04	188
4331030	200	0.6	208	0.20	0.04	208
10012295	225	0.6	233	0.18	0.03	233
4331040	300	0.6	309	0.13	0.01	309

EXHAUST, VENTILATION AND CONVEYOR HOSES

AIRDUC® PUR 351 MHF – medium heavy design



Exhaust and conveyor hose

- for abrasive solids such as dusts, powders, fibres, chippings and granulates
- for gaseous and liquid media
- for dust removal and vacuum systems
- for suction equipment, conveying equipment, compressors and compactors
- for lawnmowers and leaf vacuums
- for the food, pharma and chemical industries as a resistant protective hose
- very wear-resistant, smooth interior, optimum flow design, flexible, high tensile and tear strength
- Walls are food-compatible according to FDA 21 CFR 177.2600 and 178.2010, EC Guideline 2002/72/EC, including the most recent amended Guideline 2007/19/EC, German Recommendation XXXIX BfR polyurethane
- Permitting according to EC Guideline 2002/72/EC, including the most recent amended guideline 2007/19/EC by an independent testing institute for the entire hose
- odour-free and tasteless, resistant to microbes and hydrolysis, good oil and petroleum resistance, good chemical resistance, good UV and ozone resistance, very good flexibility in cold, minimal bending radii, kink-proof, free of plasticisers and halogens, gas-tight and liquid-tight, non-flammable according to UL94-HB
- electrically conductive (according to BGR 132, formerly ZH 1/200) when grounding the spirals

Area of application: Exhaust/conveyor hose

Design: Medium heavy version

Reinforcement: Steel wire spirals

Material: Ether PUR

Length: 10 m

Temperature range: ca. -40 °C to ca. +90 °C

Colour: Natural-transparent

Item No.	Inner diameter mm	Material thickness mm	Outer diameter mm	Operating pressure bar / 20 °C	Vacuum bar / 20 °C	Bending radius mm
10014294	25	1.0	32	2.69	0.49	35
10015592	32	1.0	40	2.12	0.46	44
4330650	40	1.0	48	1.71	0.42	53
4330660	45	1.0	53	1.52	0.38	58
4330670	50	1.0	58	1.37	0.36	64
4330680	60	1.0	68	1.15	0.28	75
4330690	65	1.0	73	1.06	0.25	80
4330700	70	1.0	79	0.99	0.21	87
4330710	75	1.0	84	0.92	0.19	92
4330720	80	1.0	89	0.86	0.17	98
4330730	90	1.0	99	0.77	0.15	109
4330740	100	1.0	109	0.69	0.12	120
4330750	110	1.0	119	0.63	0.11	131
4330760	115	1.0	124	0.60	0.10	136
4330770	120	1.0	129	0.58	0.10	142
4330780	125	1.0	134	0.56	0.08	147
4330790	130	1.0	139	0.53	0.08	153
4330800	140	1.0	149	0.49	0.08	164
4330810	150	1.0	159	0.46	0.07	175
4330820	160	1.0	169	0.43	0.06	186
4330830	175	1.0	184	0.40	0.05	202
4330840	180	1.0	189	0.38	0.05	208
4330850	200	1.0	209	0.35	0.05	230
4330860	225	1.0	234	0.31	0.04	257
4330870	250	1.0	259	0.28	0.02	285
4330880	275	1.0	284	0.25	0.02	312
4330890	300	1.0	309	0.23	0.02	340

EXHAUST, VENTILATION AND CONVEYOR HOSES



AIRDUC® PUR 355 – heavy-duty design

Exhaust and conveyor hose

- for high throughput of abrasive solids such as powders, chippings and granulates
- for gaseous and liquid media
- for industrial vacuum cleaners, granulate conveying equipment, printing machines, compactors and compressors
- as a robust protective hose
- very wear-resistant, smooth interior, optimum flow design, flexible at low weight, increased pressure and vacuum strength, high tensile and tear strength, good oil and petroleum resistance, good chemical resistance, good UV and ozone resistance, minimal bending radii, kink-proof, free of plasticisers and halogens, gas-tight and liquid-tight, non-flammable according to UL94-V2
- electrically conductive (according to BGR 132, formerly ZH 1/200) when grounding the spirals



Area of application:	Exhaust/conveyor hose
Design:	Heavy design
Reinforcement:	Steel wire spirals
Material:	Ether PUR
Length:	10 m
Temperature range:	ca. -40°C to ca. +90°C
Colour:	Natural-transparent

Item No.	Inner diameter mm	Material thickness mm	Outer diameter mm	Operating pressure bar / 20 °C	Vacuum bar / 20 °C	Bending radius mm
10003740	20	1.5	27	4.10	1.00	27
10012598	25	1.5	32	3.65	1.00	32
871610	32	1.5	42	3.26	0.97	42
1770170	35	1.5	45	3.11	0.97	45
480480	38	1.5	48	3.08	0.95	48
480490	40	1.5	50	3.05	0.95	50
481550	45	1.5	55	2.73	0.94	55
481560	50	1.5	60	2.45	0.93	60
481570	55	1.5	65	2.25	0.88	65
481580	60	1.5	70	2.06	0.81	70
481590	65	1.5	75	1.91	0.75	75
481600	70	1.5	81	1.78	0.67	97
481610	75	1.5	86	1.66	0.61	103
481620	80	1.5	91	1.56	0.56	109
481630	90	1.5	101	1.30	0.42	121
481640	100	1.5	111	1.25	0.39	133
481650	110	1.5	121	1.14	0.36	145
4350710	115	1.5	126	1.09	0.33	151
481660	120	1.5	131	1.05	0.31	157
481670	125	1.5	136	1.01	0.29	163
481680	130	1.5	141	0.96	0.27	169
481690	140	1.5	151	0.90	0.24	181
481700	150	1.5	161	0.84	0.20	193
481710	160	1.5	171	0.78	0.18	205
481720	175	1.5	186	0.72	0.15	223
481730	180	1.5	191	0.70	0.15	229
481740	200	1.5	213	0.63	0.13	256
481750	225	1.5	238	0.56	0.11	286
481760	250	1.5	263	0.51	0.08	316
481770	275	1.5	288	0.46	0.08	346
481780	300	1.5	313	0.42	0.07	376

EXHAUST, VENTILATION AND CONVEYOR HOSES

TIMBERDUC® PUR 533 SE – heavy-duty design



Exhaust and conveyor hose

- wall made of non-flammable polyurethane resistant to aggressive woods and wood preservatives
- for the exhausting of wood dust and chips in woodworking machines
- for abrasive solids such as dusts, powders, fibres, chippings and granulates
- for dust removal and vacuum systems
- as a resistant protective hose
- meets the safety requirements of the German Holz-BG
- very wear-resistant
- smooth interior
- optimum flow design
- flexible
- high tensile and tear strength
- resistant to microbes and hydrolysis
- good oil and petroleum resistance
- good chemical resistance
- good UV and ozone resistance
- minimum bending radii
- kink-proof
- halogen-free
- gas-tight and liquid-tight
- non-flammable according to DIN 4102-B1
- conductive (according to BGR 132, formerly ZH 1/200) for grounding of coils

Area of application:	Exhaust/conveyor hose
Design:	Heavy design
Reinforcement:	Steel wire spirals
Material:	Ether PUR
Length:	10 m
Norm:	DIN 4102-B1
Temperature range:	ca. -40 °C to ca. +90 °C
Colour:	Natural-transparent

Item No.	Inner diameter mm	Material thickness mm	Outer diameter mm	Vacuum bar / 20 °C	Bending radius mm
4400640	40	0.7	48	0.42	53
4169910	50	0.7	58	0.36	64
4169920	60	0.7	68	0.28	75
4169930	70	0.7	79	0.21	87
4169940	75	0.7	84	0.19	92
4169950	80	0.7	89	0.17	98
4361740	90	0.7	99	0.15	109
4169960	100	0.7	109	0.12	120
4169970	110	0.7	119	0.11	131
4169980	120	0.7	129	0.10	142
4169990	125	0.7	134	0.08	147
4718720	130	0.7	139	0.08	153
4170000	140	0.7	149	0.08	164
4170010	150	0.7	159	0.07	175
4170020	160	0.7	169	0.06	186
4170030	180	0.7	189	0.05	208
4170040	200	0.7	209	0.05	230
4170050	225	0.7	234	0.04	257
4170060	250	0.7	259	0.02	285
4170070	300	0.7	309	0.02	340
4170080	315	0.7	324	0.02	356
4170090	350	0.7	359	0.01	395
4170100	400	0.7	409	0.01	450

EXHAUST, VENTILATION AND CONVEYOR HOSES



PROTAPE® PVC 310

Exhaust and blower hose, super-light, highly flexible and compressible 3:1, electrically conductive

Applications: for fine solids such as dusts, powders and fibres; for gaseous media such as vapours and smoke; for air conditioning systems

Properties: optimum flow design, good resistance against acids and bases; good chemical resistance; non-flammable according to UL94-HB;

conductive (according to BGR 132, formerly ZH 1/200) for grounding of coils

Construction: PROTAPE® film tube; spring steel wire embedded in the walls; wall: high-quality soft PVC; wall thickness ca. 0.6 mm; spirals: Spring steel wire

Temperature range: ca. -20°C to ca. +70°C, short-term up to ca. +80°C



AIRDUC® PVC 341

Exhaust and conveyor hose, lightweight, smooth interior, electrically conductive

Applications: for solids such as dusts, powders and fibres; for gaseous and liquid media; for dust removal and vacuum systems, air conditioning systems; as resistant protective hose

Properties: optimum flow design, good resistance against acids and bases; good chemical resistance; non-flammable according to UL94-HB;

conductive (according to BGR 132, formerly ZH 1/200) for grounding of coils

Construction: AIRDUC® profiled hose; spring steel wire cast in the wall; wall: high-quality soft PVC; wall thickness ca. 0.9 mm;

spirals: Spring steel wire

Temperature range: ca. -20°C to ca. +70°C, short-term up to ca. +80°C



NORPLAST® PVC-CU 384

Exhaust and conveyor hose, heavyweight, smooth interior, grounding wire

Applications: for solids such as powders, chippings and granulates; for gaseous and liquid media; for dust removal and vacuum systems, air conditioning systems; as a robust protective hose

Properties: increased pressure and vacuum resistance; high axial strength; good resistance to acids and bases; good chemical resistance; gas-tight and liquid-tight; walls are food-compatible

Construction: hard plastic spirals embedded in the wall; wall: high-quality soft PVC, spirals: hard PVC; metal grounding wire

Temperature range: ca. -5°C to ca. +70°C, short-term up to ca. +80°C



PROTAPE® PUR 331 MHF

Exhaust and blower hose, super-light, highly flexible and compressible 4:1, electrically conductive

Applications: for fine solids such as dusts, powders, fibres and chippings; for gaseous media such as oil vapours and welding smoke; for dust removal and vacuum systems

Properties: resistant to microbes and hydrolysis; good chemical resistance; Wall is food-compatible according to FDA 21 CFR 177.2600 and 178.2010, EC Guideline 2002/72/EC including the most recent amended Guideline 2007/19/EC, German recommendation XXXIX BfR polyurethane; electrically conductive (up to Ø 149 mm according to BGR 132, formerly ZH 1/200) for grounding of spirals

Construction: PROTAPE® Film tube; spring steel wire embedded in the wall; wall: special premium ether polyurethane; wall thickness ca. 0.4 mm;

Coils: Spring steel wire

Temperature range: ca. -40°C to ca. +90°C, short-term up to ca. +125°C



EXHAUST, VENTILATION AND CONVEYOR HOSES



AIRDUC® PUR-VA 351 MHF

Exhaust and conveyor hose, medium weight, smooth interior, electrically conductive

Applications: for solids such as dusts, powders, fibres and granulates; for gaseous and liquid media; for suction equipment, conveying equipment, compactors and compressors; for the food, pharma and chemical industries

Properties: flow-optimised, resistant to microbes and hydrolysis; good chemical resistance; wall is food-compatible according to FDA 21 CFR 177.2600 and 178.2010, EC Guideline 2002/72/EC, including the most recent amended Guideline 2007/19/EC German Recommendation XXXIX BfR polyurethane; non-flammable according to UL94-HB; electrically conductive (according to BGR 132, formerly ZH 1/200) when grounding the spirals

Construction: AIRDUC® profiled hose; spring steel wire cast in the wall; wall: special premium ether polyurethane; wall thickness ca. 0.9 mm; Coils: Stainless steel wire (VA)

Temperature range: ca. -40 °C to ca. +90 °C, short-term up to ca. +125 °C



AIRDUC® HT-PUR 351

Exhaust and conveyor hose, medium weight, smooth interior, electrically conductive

Applications: for hot and abrasive solids such as dusts, powders, fibres and granulates; for gaseous and liquid media; for dust removal and vacuum systems, industrial vacuum cleaners, vacuuming of paper and textile fibres; for printing machines, compactors and compressors

Properties: flow-optimised; very good heat resistance; good chemical resistance; good UV and ozone resistance; electrically conductive (up to Ø 149 mm according to BGR 132, formerly ZH 1/200) for grounding of spirals

Construction: AIRDUC® profiled hose; spring steel wire cast in the wall; wall: special premium high temperature polyurethane; wall thickness ca. 0.9 mm; Coils: Spring steel wire

Temperature range: ca. -40 °C to ca. +125 °C, short-term up to ca. +150 °C



TIMBERDUC® PUR 532 SE

Non-flammable exhaust and blower hose for the wood industry, lightweight, highly flexible and compressible: 3:1

Applications: for vacuuming of wood dust and chips in woodworking machines; for abrasive solids such as dusts, powders, fibres and chippings; for dust removal and vacuuming systems

Properties: flow-optimised; resistant to microbes and hydrolysis; good chemical resistance; non-flammable according to UL94-V0, DIN 4102-B1; meets safety regulations of the German Holz-BG; electrically conductive (according to BGR 132, formerly ZH 1/200) for grounding spirals

Construction: PROTAPE® film tube; spring steel wire embedded in the wall; wall: special premium ether polyurethane with flame-resistant additive; wall thickness ca. 0.6 mm; spirals: Spring steel wire

Temperature range: ca. -40 °C to ca. +90 °C, short-term up to ca. +125 °C

EXHAUST, VENTILATION AND CONVEYOR HOSES



BARDUC® PUR-VA 382 MHF

Wear-resistant exhaust and conveyor hose, super-heavy-duty, smooth interior and exterior, resistant to vacuum, electrically conductive

Applications: for high throughput in extremely abrasive solids such as sand, gavel, grains, fragments and chippings; for gaseous and fluid media; for silo vehicles; as conveyor hoses in glass works, harbour facilities, steel plants, quarries, shipyards, cement plants, etc.; as a robust protective hose

Properties: very high pressure, vacuum and bending strength; high axial strength; flow-optimised, resistant to microbes and hydrolysis; good chemical resistance; wall is food-compatible according to FDA 21 CFR 177.2600 and 178.2010, EC Guideline 2002/72/EC, including the most recent amended Guideline 2007/19/EC, German recommendation XXXIX BfR polyurethane; electrically conductive (according to BGR 132, formerly ZH 1/200) for grounding of spirals

Construction: BARDUC® construction; spring steel wire cast in the wall; wall: special premium ether polyurethane; spirals: Stainless steel wire (VA)

Temperature range: ca. -40°C to ca. +90°C, short-term up to ca. +125°C



NORPLAST® PUR 385

Wear-resistant suction and conveying hose, lightweight, smooth interior

Applications: for abrasive solids such as dusts, powders, fibres, chippings and granulates; for gaseous and liquid media; for dust removal and vacuum systems, industrial vacuum cleaners, vacuuming of paper and textile fibres; as a resistant protective hose

Properties: resistant to microbes and hydrolysis; good chemical resistance; gas-tight and liquid-tight; wall is food-compatible according to FDA 21 CFR 177.2600 and 178.2010, EC guideline 2002/72/ED including the most recent amended guideline 2007/19/EC, German recommendation XXXIX BfR polyurethane

Construction: Hard plastic winding embedded in the wall;

Wall: Ether polyurethane; spirals: Hard PVC

Temperature range: ca. -20°C to ca. +70°C, short-term up to ca. +80°C



AIRDUC® PUR 356 MHF reinforced

Wear-resistant suction and conveying hose, super-heavy-duty and reinforced, smooth interior, vacuum-resistant, electrically conductive

Applications: for high throughput in extremely abrasive solids such as sand, gavel, grains, fragments and chippings; for gaseous and fluid media; for silo vehicles; as conveyor hoses in glass works, harbour facilities, steel plants, quarries, shipyards, cement plants, etc.; as a robust protective hose

Properties: extreme wear-resistance due to targeted reinforcement beneath the wire and small hose gradient; very high pressure, vacuum and bending strength; high axial strength; flow-optimised, resistant to microbes and hydrolysis; good chemical resistance; wall is food-compatible according to FDA 21 CFR 177.2600 and 178.2010.

EC guideline 2002/72/ED including the most recent amended guideline 2007/19/EC, German recommendation XXXIX BfR polyurethane; electrically conductive (according to BGR 132, formerly ZH 1/200) for grounding of spirals

Construction: AIRDUC® profiled hose; spring steel wire cast in the wall; wall: special premium ether polyurethane; spirals: Spring steel wire

Temperature range: ca. -40°C to ca. +90°C, short-term up to ca. +125°C

EXHAUST, VENTILATION AND CONVEYOR HOSES

High-temperature hose CP HYPALON® 450



Exhaust and blower hose

- for aggressive solids such as dusts, powders and fibres
- for aggressive gaseous media such as vapours and smoke
- for exhaust gas technologies, engine technologies and engine pre-heating
- for dust removal and vacuuming systems
- for stack gas, furnace and welding smoke vacuuming
- as a bellows and expansion joint
- for the chemical industry
- vibration-resistant
- very heat-resistant
- highly flexible and compressible to 4:1 ratio
- scuff protection through external clamp profile
- strong clamping of the wall in the clamp profile
- good oil and petroleum resistance
- good resistance to acids and bases
- good chemical resistance
- good UV and ozone resistance
- minimal bending radii
- kink-proof
- low weight

Area of application: Exhaust/blower hose
Reinforcement: Clamping profile, galvanised steel
Material: Hypalon® - coated polyester fabric
Length: 6 m
Temperature range: ca. -40 °C to ca. +170 °C
Colour: black

Item No.	Inner diameter mm	Outer diameter mm	Operating pressure bar / 20 °C	Vacuum bar / 20 °C	Bending radius mm
890270	50	62	0.70	0.38	50
1072300	55	67	0.66	0.35	54
1072310	60	72	0.63	0.32	58
1072320	65	77	0.60	0.29	62
1072330	70	82	0.57	0.26	66
1072340	75	87	0.54	0.23	70
1072350	80	92	0.52	0.20	74
1072360	90	102	0.48	0.14	82
1072370	100	112	0.32	0.12	78
883150	110	122	0.30	0.10	85
1072400	120	132	0.28	0.09	92
1072420	125	137	0.27	0.08	96
1072440	130	142	0.27	0.07	99
1072460	140	152	0.25	0.06	106
1072470	150	162	0.17	0.05	113
1072480	160	172	0.16	0.04	120
1072500	170	182	0.16	0.04	127
1072540	175	187	0.15	0.04	131
1072550	180	192	0.15	0.04	134
1072560	200	212	0.14	0.03	148
1072580	215	227	0.13	0.03	159
1072590	225	237	0.13	0.02	166
1072600	250	262	0.10	0.02	183
1072610	275	287	0.09	0.02	201
1072630	300	312	0.09	0.01	218

EXHAUST, VENTILATION AND CONVEYOR HOSES



High-temperature hose CP SILICON 460

Exhaust and blower hose

- for solids such as dusts, powders and fibres
- for gaseous media such as vapours and smoke
- for dust removal and vacuuming systems
- for stack gas, furnace and welding smoke vacuuming
- as a bellows and expansion joint
- very heat-resistant
- highly flexible and compressible to 4:1 ratio
- scuff protection through external clamp profile
- strong clamping of the wall in the clamp profile
- minimal bending radii
- kink-proof
- low weight
- non-flammable according to DIN 4102-B1

Area of application: Exhaust/blower hose
Reinforcement: Clamping profile, galvanised steel
Material: Silicone-coated glass fabric
Length: 6 m
Norm: DIN 4102-B1
Temperature range: ca. -70 °C to ca. +260 °C
Colour: silver-grey



Item No.	Inner diameter mm	Outer diameter mm	Operating pressure bar / 20 °C	Vacuum bar / 20 °C	Bending radius mm
1072670	50	62	0.56	0.30	43
1072680	55	67	0.53	0.28	47
1072700	60	72	0.50	0.25	50
1072710	65	77	0.48	0.23	54
1072720	70	82	0.45	0.21	57
1072730	75	87	0.43	0.18	61
1072740	80	92	0.42	0.16	64
1072750	90	102	0.38	0.11	71
1072760	100	112	0.25	0.10	78
1072770	110	122	0.24	0.08	85
1072780	120	132	0.22	0.07	92
1072790	125	137	0.22	0.07	96
1072800	130	142	0.21	0.06	99
1072810	140	152	0.20	0.05	106
1072820	150	162	0.14	0.04	113
1072830	160	172	0.13	0.03	120
1072840	170	182	0.13	0.03	127
1072850	175	187	0.12	0.03	131
1072860	180	192	0.12	0.03	134
1072870	200	212	0.11	0.02	148
1072880	215	227	0.11	0.02	159
1072890	225	237	0.10	0.02	166
1072900	250	262	0.08	0.02	183
1072910	275	287	0.07	0.01	201
1072920	300	312	0.07	0.01	218

EXHAUST, VENTILATION AND CONVEYOR HOSES

CP hoses



CP PE 457

Exhaust and blower hose, PE, super-lightweight and compressible, Ø up to 1.000 mm

Applications: for aggressive solids such as dusts, powders and fibres; for gaseous media such as vapours and smoke; for air conditioning systems; as a bellows and expansion joint; for asbestos disposal

Properties: Scuff protection through external clamp profile; good chemical resistance; odourless and tasteless

Construction: patented CP construction; wall: polyethylene mixed fabric (LDPE + HDPE); clamp profile: Galvanised steel

Temperature range: ca. -35°C to ca. +80°C



CP VITON® 459 EL

Electrically conductive exhaust and blower hose, VITON® <10⁴ Ω, super-lightweight and compressible, Ø up to 1.000 mm, electrically conductive

Applications: in explosive areas (EX protection); for aggressive solids such as dusts, powders and fibres; for aggressive gaseous media such as vapours and smoke; as a bellows and expansion joint; for dust removal and vacuuming systems

Properties: Scuff protection through external clamp profile; good resistance to acids and bases; good chemical resistance; Resistivity and surface resistance <10⁴ Ω; meets the requirements of European ATEX Guideline;

electrically conductive (according to BGR 132, formerly ZH 1/200) for grounding spirals

Construction: patented CP construction;

Wall: Viton® - coated polyester fabric; clamp profile: Galvanised steel

Temperature range: ca. -20°C to ca. +210°C



CP ARAMID 461

High-temperature exhaust and blower hose, silicone, vibration-resistant, very robust, Ø up to 1.000 mm

Applications: for applications in which non-combustible hoses are prescribed; for solids such as dusts, powder and reinforcement fibres (tension support); for gaseous media such as vapours and smoke; for dust removal and vacuuming systems, flue gas, furnace and welding gas suction; as a bellows and expansion joint

Properties: vibration-resistant; scuff protection through external clamp profile; good chemical resistance; non-flammable according to: DIN 4102-B1; very robust

Construction: patented CP construction; wall: specially-coated high-temperature fabric; clamp profile: Galvanised steel

Temperature range: ca. -60°C to ca. +260°C, short-term up to ca. +300°C

EXHAUST, VENTILATION AND CONVEYOR HOSES

CP hoses

CP PTFE/Glas-VA 471

Exhaust and blower hose, TEFLON®, two-layered, super-lightweight and compressible, Ø up to 1.000 mm

Applications: for aggressive solids such as dusts, powders and fibres; for aggressive gaseous media such as vapours and smoke; as a bellows and expansion joint for dust removal and vacuuming systems; for the chemical industry

Properties: Scuff protection through external clamp profile; good resistance to acids and bases; extremely good chemical resistance

Construction: Patented CP construction; wall: inner PTFE film, specially coated glass fabric; clamp profile: full stainless steel (VA)

Temperature range: ca. -150°C to ca. +250°C, short-term up to ca. +270°C



CP HiTex 480

High-temperature suction hose, super-lightweight, highly flexible and compressible, Ø up to 1.000 mm

Applications: for applications in which non-combustible hoses are prescribed; for solids such as dusts, powder and reinforcement fibres (tension support); for gaseous media such as vapours and smoke; for dust removal and vacuuming systems, flue gas, furnace and welding gas suction; as a bellows and expansion joint

Properties: Scuff protection through external clamp profile; non-flammable according to DIN 4102-B1

Construction: patented CP construction; wall: reinforced with stainless steel wires and specially-coated glass fabric; clamp profile: Galvanised steel

Temperature range: ca. -60°C to ca. +400°C, short-term up to ca. +450°C



CP HiTex 483

High-temperature exhaust and blower hose, multi-layered, robust, insulated, extremely heat-resistant

Applications: for solids such as dusts, powder and fibres; for gaseous media such as vapours and smoke; for dust removal and vacuuming systems, flue gas, furnace and welding gas exhaust; for exhaust gas technology, engine technology and engine pre-heating; as a bellows and expansion joint

Properties: Scuff protection through external clamp profile; very robust

Construction: patented CP construction; wall: reinforced inside with stainless steel wires and specially-coated glass fabric, thermal insulation fabric, externally specially coated glass fabric; clamp profile: full stainless steel (VA)

Temperature range: ca. -60°C to ca. +900°C, short-term up to ca. +1.100°C



EXHAUST, VENTILATION AND CONVEYOR HOSES

Hot air hose NEO 1-layer



Exhaust and blower hose

- to route hot and cold air
- for granulate dryers in the plastics industry
- for printing machines, compressors
- for exhaust gas technology, motor technology and motor preheating
- single-layer
- very heat-resistant
- dense
- highly flexible
- fibre-reinforced
- very small bending radii
- does not kink
- low weight

Area of application: Exhaust/blower hose

Design: 1-layer

Reinforcement: Steel wire spirals

Material: Neoprene-coated glass fabric

Length: 4 m

Temperature range: ca. -50 °C to ca. +150 °C

Colour: black

Item No.	Inner diameter mm	Outer diameter mm	Operating pressure bar / 20 °C	Vacuum bar / 20 °C	Bending radius mm
4401160	19	21	1.80	0.58	21
4401170	22	24	1.80	0.58	24
4401180	25	29	1.50	0.58	29
4401190	32	35	1.50	0.58	35
4401200	38	42	1.50	0.58	42
4401210	44	48	1.50	0.56	48
4401220	51	55	1.50	0.50	55
4401230	57	61	1.30	0.50	61
4401240	63	67	1.30	0.50	67
4401250	70	74	1.20	0.50	74
4401260	76	80	1.10	0.39	80
10040102	80	84	1.10	0.39	84
4401270	83	87	1.10	0.39	87
4401280	89	93	1.10	0.38	93
4401290	95	99	1.10	0.38	99
4401300	102	106	1.10	0.30	106
4401310	108	113	1.00	0.30	113
4401320	114	119	1.00	0.30	119
4401330	121	126	0.90	0.29	126
4401340	127	132	0.90	0.21	132
4401350	140	145	0.90	0.20	145
4401360	152	157	0.80	0.18	157
4401370	178	183	0.60	0.14	183
4401380	203	208	0.60	0.10	208
4401390	254	259	0.40	0.10	259
4401400	305	310	0.10	0.07	310

EXHAUST, VENTILATION AND CONVEYOR HOSES



Hot air hose SIL 1-layer

Exhaust and blower hose

- to route hot and cold air
- for granulate dryers in the plastics industry
- for printing machines, compressors
- for exhaust gas technology, motor technology and motor preheating
- single-layer
- very heat-resistant
- dense
- highly flexible
- fibre-reinforced
- very small bending radii
- does not kink
- low weight

Area of application: Exhaust/blower hose
Design: 1-layer
Reinforcement: Steel wire spirals
Material: Silicone-coated glass fabric
Length: 4 m
Temperature range: ca. -70°C to ca. +260°C
Colour: red



Item No.	Inner diameter mm	Outer diameter mm	Operating pressure bar / 20 °C	Vacuum bar / 20 °C	Bending radius mm
4401740	19	21	1.80	0.58	21
4401750	22	24	1.80	0.58	24
4401760	25	29	1.50	0.58	29
4401770	32	35	1.50	0.58	35
4401780	38	42	1.50	0.58	42
4401790	44	48	1.50	0.56	48
4401800	51	55	1.50	0.50	55
4401810	57	61	1.30	0.50	61
4401820	63	67	1.30	0.50	67
4401830	70	74	1.20	0.50	74
4401840	76	80	1.10	0.39	80
10040101	80	84	1.10	0.39	84
4401850	83	87	1.10	0.39	87
4401860	89	93	1.10	0.38	93
4401870	95	99	1.10	0.38	99
4401880	102	106	1.10	0.30	106
4401890	108	113	1.00	0.30	113
4401900	114	119	1.00	0.30	119
4401910	121	126	0.90	0.29	126
4401920	127	132	0.90	0.21	132
4401930	140	145	0.90	0.20	145
4401940	152	157	0.80	0.18	157
4401950	178	183	0.60	0.14	183
4401960	203	208	0.60	0.10	208
4401970	254	259	0.40	0.10	259
4401980	305	310	0.10	0.07	310

EXHAUST, VENTILATION AND CONVEYOR HOSES

Air-conditioning hose – super-lightweight design



Exhaust and blower hose for air conditioning
To exhaust smoke, vapour, dust and gaseous media.
• highly flexible and compressible at 6:1

Area of application: Exhaust/blower hose
Design: super-light design
Reinforcement: Steel wire spirals
Material: PVC-coated fabric
Length: 10 m
Temperature range: ca. -10 °C to ca. +100 °C
Colour: grey

Item No.	Inner diameter mm	
1005610	51	
459730	80	
459740	102	
876320	127	
1067990	152	
4385060	180	
1205730	203	

EXHAUST, VENTILATION AND CONVEYOR HOSES



Stripwound metal hose with glass fibre seal

suction hose

- for solids such as powders, chippings and granulates
- for gaseous media
- for dust removal and vacuuming systems, air conditioning
- for exhaust gas technology, engine technology and engine pre-heating
- for stack gas exhaust, furnace exhaust and engine test stands
- as a expansion joint
- as a robust protective hose
- resistivity and surface resistance < 10 high 3 Ohms
- very good heat-resistance
- wear-resistant
- flexible
- very robust
- non-flammable
- meets the requirements of the European ATEX Guideline
- electrically conductive (according to BGR 132, formerly ZH 1/200) for grounding

Area of application: Suction hose
Design: with glass fibre seal
Material: Galvanised steel
Temperature range: up to ca. +400 °C



Item No.	Inner diameter mm	Outer diameter mm	Length m	Bending radius mm
193230	20	24	10	100
193240	25	29	10	110
193250	30	34	10	130
193260	35	39	10	150
193270	40	45	10	155
193280	45	50	10	165
193290	50	55	10	180
193300	60	66	10	215
568810	65	71	10	230
193310	70	76	10	240
193320	75	81	10	255
193330	80	86	10	270
193340	90	97	10	280
193350	100	107	10	300
193360	110	117	10	330
193370	120	127	10	380
193380	125	132	10	400
193390	130	139	10	410
193400	140	149	10	430
193410	150	159	10	460
193420	160	169	10	490
193450	180	189	10	545
193460	200	211	5	560
193470	225	236	5	630
193480	250	261	5	700
193490	300	311	5	850

EXHAUST GAS HOSES

PROTAPE® TPE 326 MEMORY exhaust gas hoses



Exhaust hose

- for the suctioning of engine exhaust gases
- for exhaust gas hose rollers
- for slotted suction channels
- for above-floor and sub-floor exhaust systems
- vibration-resistant
- can be driven upon
- highly flexible and compressible
- flow-optimised outer folding
- fabric-reinforced
- good chemical resistance
- minimal bending radii
- gas-tight and liquid-tight
- low weight

Area of application: Exhaust gas hose
Reinforcement: plastic hollow spirals
Material: EPDM/PP coated fabric
Temperature range: up to ca. +200 °C
Colour: black

Item No.	Inner diameter mm	Outer diameter mm	Length m	Vacuum bar / 20 °C	Bending radius mm
4402440	51	68	15	0.40	82
4402450	63	80	15	0.28	101
4402460	76	93	15	0.17	111
4457910	102	119	15	0.05	122
4457920	127	144	15	0.03	152
4457930	152	169	15	0.03	182
4457940	203	220	15	0.01	244

EXHAUST GAS HOSES



CP ARAMID 461 PROTECT exhaust gas hose

Exhaust hose

- for the suctioning of engine exhaust gases
- for exhaust gas hose rollers
- for slotted suction channels
- for above-floor and sub-floor exhaust systems
- vibration-resistant
- outer protective profile made of elastic material
- very heat-resistant
- highly flexible and compressible
- scuff protection through external clamp profile
- strong clamping of the wall in clamp profile
- good chemical resistance
- minimal bending radii
- kink-proof
- low weight
- very robust
- non-flammable
- incl. a outer clamp cover strip and two end caps

Area of application: Exhaust gas hose
Reinforcement: Clamp profile, steel galvanised; protective profile, high-temperature plastic
Material: specially-coated fabric
Temperature range: up to ca. +300 °C
Colour: grey



Item No.	Inner diameter mm	Outer diameter mm	Length m	Vacuum bar / 20°C	Bending radius mm
4402550	75	89	2.5 / 5 / 7.5	0.23	85
4457840	76	90	2.5 / 5 / 7.5	0.22	86
4402560	80	94	2.5 / 5 / 7.5	0.20	89
4402570	90	104	2.5 / 5 / 7.5	0.14	99
4402580	100	114	2.5 / 5 / 7.5 / 10 / 12.5 / 15	0.12	108
4457850	102	116	2.5 / 5 / 7.5 / 10 / 12.5 / 15	0.11	110
4402590	110	124	2.5 / 5 / 7.5 / 10 / 12.5 / 15	0.10	118
4402600	120	134	2.5 / 5 / 7.5 / 10 / 12.5 / 15	0.09	127
4402610	125	139	2.5 / 5 / 7.5 / 10 / 12.5 / 15	0.08	132
4457860	127	141	2.5 / 5 / 7.5 / 10 / 12.5 / 15	0.08	134
4402620	130	144	2.5 / 5 / 7.5 / 10 / 12.5 / 15	0.07	137
4402630	140	154	2.5 / 5 / 7.5 / 10 / 12.5 / 15	0.06	146
4402640	150	164	2.5 / 5 / 7.5 / 10 / 12.5 / 15	0.05	156
4457870	152	166	2.5 / 5 / 7.5 / 10 / 12.5 / 15	0.05	158
4402650	160	174	2.5 / 5 / 7.5 / 10 / 12.5 / 15	0.04	165
4402660	170	184	2.5 / 5 / 7.5 / 10 / 12.5 / 15	0.04	175
4402670	175	189	2.5 / 5 / 7.5 / 10 / 12.5 / 15	0.04	180
4402680	180	194	2.5 / 5 / 7.5 / 10 / 12.5 / 15	0.04	184
4402690	200	214	2.5 / 5 / 7.5 / 10 / 12.5 / 15	0.03	203
4457880	203	217	2.5 / 5 / 7.5 / 10 / 12.5 / 15	0.03	206
4457890	250	264	2.5 / 5 / 7.5 / 10 / 12.5 / 15	0.02	250

EXHAUST, VENTILATION AND CONVEYOR HOSES

Hose clamps, connection parts, couplings, connectors

For the different NORRES hoses and their many applications, different fastening options and connection parts are also required. From simple clamps to heat-shrink sleeves and connecting parts for metal hoses to a solid cast connection part. The accessory indicated is tailored specifically for the NORRES hoses. Thus, fit and optimum seal is ensured.

Spiral clamp 212

Special clamp for fastening externally-corrugated spiral hoses.
Fits most AIRDUC®, PROTAPE®, CP and TIMBERDUC® hoses.



Grounded spiral clamp 212

Special clamp with integrated grounding cable or strip for fastening externally-corrugated spiral hoses.
Fits most AIRDUC® hoses and TIMBERDUC® 534.



Spiral clamp with quick-acting closure 213

Special clamp with quick-acting closure for fastening externally-corrugated spiral hoses.
Fits most AIRDUC®, PROTAPE®, CP and TIMBERDUC® hoses.



Spiral clamp with fastening eyelet 217

Special clamp with fastening eyelet for fastening externally corrugated spiral hoses.
Fits most AIRDUC®, PROTAPE®, CP and TIMBERDUC® hoses.



Sealing clamp 216

Special clamp for water-tight fastening of heavy-duty and externally corrugated spiral hoses.
Fits AIRDUC® 355 and 356, as well as TIMBERDUC® 534.



Shell strap system

Flow-optimised coupling system for silo vehicles.
Fits AIRDUC® 356 MHF reinforced NW 75 and 100 mm.



EXHAUST, VENTILATION AND CONVEYOR HOSES



Hose clamps, connection parts, couplings, connectors

CONNECT threaded fittings 242

Threaded connection compatible to common coupling and connection systems such as Storz, Perrot, Kamlok, ...
Fits most AIRDUC®, BARDUC® and TIMBERDUC® hoses.

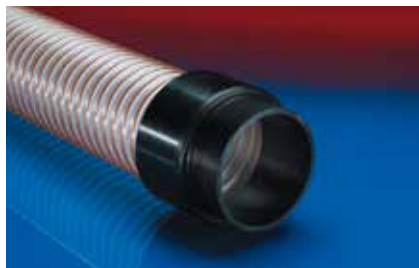

CONNECT swivel flange 244

Flange fitting mating flanges according to DIN 2632/2633, hold pattern according to DIN 2501.
Fits most AIRDUC®, BARDUC® and TIMBERDUC® hoses.



CONNECT TRI-Clamp 245

Coupling fitting nozzles according to DIN 32676.
Fits most AIRDUC®, BARDUC® and TIMBERDUC® hoses.



Heat-shrink sleeves 223

To connect hoses together or from hose to nozzle.
Fits almost all NORRES hoses.



Sheet-metal hose connector/reducer 270 - 271

To connect, reduce and expand hose lines.
Fits almost all NORRES hoses.



Connection parts 202 - 206

Nozzles, flanges and couplings to connect and fasten metal hoses.
Fits metal hose 375, 376 and 377.



PLASTIC SPIRAL HOSES

PVC spiral hose REIFF StandardFLEX



PVC spiral hose for conveying and suctioning liquid and grainy media in the construction industry, gardening, agriculture, wood and paper industry and for irrigation and de-watering work.

- UV and weather-resistant, lightweight, flexible, wear-resistant, resistant to numerous chemicals
- smooth interior, slightly corrugated on the outside

Area of application: Suction and pressure hose
Reinforcement: Hard PVC spirals
Material: PVC
Temperature range: ca. -10 °C to ca. +60 °C
Colour: green-transparent, white spirals

Item No.	Inner diameter mm	Wall thickness mm	Operating pressure bar / 20 °C	Vacuum bar / 20 °C	Bending radius mm
457420	13	2.7	10	0.70	75
457430	16	2.8	8	0.70	90
192360	20	2.4	5	0.60	110
192370	25	2.4	5	0.60	140
192380	30	2.5	5	0.60	170
192390	32	2.6	5	0.60	180
192400	35	2.6	5	0.60	195
192410	38	3.0	5	0.60	210
192420	40	3.0	5	0.60	220
192430	45	3.2	5	0.60	250
192440	50	3.6	5	0.60	270
192450	60	3.6	5	0.60	330
686230	63	3.7	5	0.60	350
192460	70	3.9	4	0.60	450
192470	75	4.1	4	0.60	500

Item No.	Inner diameter mm	Wall thickness mm	Operating pressure bar / 20 °C	Vacuum bar / 20 °C	Bending radius mm
478480	80	4.5	4	0.60	550
641410	90	5.3	4	0.70	420
192480	100	5.7	4	0.70	470
641420	110	6.1	4	0.60	520
641440	125	6.2	3	0.55	680
1068080	150	7.3	3	0.50	780

Item No.	Inner diameter mm	Wall thickness mm	Operating pressure bar / 20 °C	Vacuum bar / 20 °C	Bending radius mm
1068070	200	8.4	2	0.45	1000

PLASTIC SPIRAL HOSES

PVC spiral hose REIFF VakuumFLEX

PVC spiral hose for suctioning air, smoke and gaseous media.

- UV and weather-resistant, lightweight, flexible, resistant to numerous chemicals
- smooth interior, corrugated on the outside

Area of application: Suction hose
Reinforcement: Hard PVC spirals
Material: PVC
Temperature range: ca. -10°C to ca. +50°C
Colour: grey, white spirals



Item No.	Inner diameter mm	Wall thickness mm	Vacuum bar / 20°C	Bending radius mm
603850	13	2.4	0.45	20
786800	16	2.4	0.45	22

Item No.	Inner diameter mm	Wall thickness mm	Vacuum bar / 20°C	Bending radius mm
10085841	19	2.0	0.40	19
192850	25	2.5	0.40	32
192860	30	2.9	0.35	35
192870	32	3.0	0.35	40
192880	35	3.0	0.35	42
192890	38	3.2	0.30	45
192900	40	3.3	0.30	50
192910	45	3.5	0.30	55
192920	50	3.9	0.30	60
192930	60	4.0	0.30	68
619050	63	4.0	0.30	70
462970	70	4.2	0.30	85

Item No.	Inner diameter mm	Wall thickness mm	Vacuum bar / 20°C	Bending radius mm
192940	75	4.3	0.25	100
772370	80	4.9	0.25	140
1047950	90	5.0	0.25	150
192950	100	5.6	0.25	155
1068180	110	5.8	0.25	170
1047960	120	5.8	0.25	180
1072060	125	5.8	0.25	190
1072070	150	6.3	0.20	200

Item No.	Inner diameter mm	Wall thickness mm	Vacuum bar / 20°C	Bending radius mm
928120	200	6.8	0.15	240

PLASTIC SPIRAL HOSES

PVC spiral hose SPIRAMET

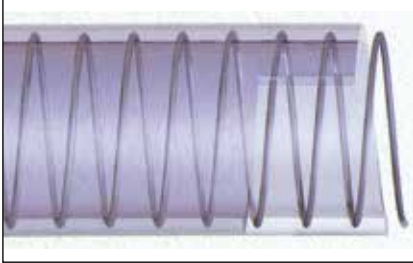

PVC spiral hose for conveying and suctioning liquid media.

- UV and weather-resistant, flexible, resistant to numerous chemicals
- smooth inside and outside

Area of application: Suction and pressure hose
Reinforcement: Steel wire spirals
Material: PVC
Temperature range: ca. -10 °C to ca. +60 °C
Colour: transparent

Item No.	Inner diameter mm	Wall thickness mm	Operating pressure bar / 20 °C	Vacuum bar / 20 °C	Bending radius mm
1009810	10	2.7	7	0.85	18
1072100	12	2.7	6	0.85	23
908490	13	3.1	6	0.90	45
1072110	14	2.7	6	0.85	26
1072120	16	3.0	6	0.85	30
1072140	18	3.2	5	0.85	32
908510	19	3.5	5	0.90	65
1072150	20	3.5	5	0.85	34
1072160	22	3.5	5	0.85	38
686190	25	4.0	5	0.85	42
1072170	30	4.0	4	0.85	50
686200	32	4.2	4	0.85	53

Item No.	Inner diameter mm	Wall thickness mm	Operating pressure bar / 20 °C	Vacuum bar / 20 °C	Bending radius mm
686210	38	4.5	4	0.85	63
1072200	40	4.6	4	0.85	66
1072210	45	4.9	4	0.80	74
641710	50	5.0	4	0.80	82
1072240	60	5.9	3.60	0.80	130
641720	75	6.1	3.60	0.70	164

PLASTIC SPIRAL HOSES

PVC spiral hose SPIRAMET

Item No.	Inner diameter mm	Wall thickness mm	Operating pressure bar / 20 °C	Vacuum bar / 20 °C	Bending radius mm	
686220	80	6.1	3.60	0.70	172	
641730	102	6.5	2.40	0.70	215	
1072250	120	8.7	1.20	0.90	340	
1072270	150	9.3	1.20	0.90	450	

CHEMICAL HOSES

Chemical hose RESIST U UPEL®



Chemical safety hose with black, conductive UPE layer.

Suitable for the transport of acids, bases, salts, organic compounds (alcohols, esters, ketones, etc.) including aromatics, chlorinated hydrocarbons and oxidising acids.

The Resist U core has a low coefficient of friction and good wear resistance.

- Temperature range: The core, depending on the flow medium up to +100 °C, hose flexible down to -35 °C, steam cleaning pressure-less up to 130 °C / max. 30 min
- Safety factor: 4 : 1
- Core: UPE, black, smooth, electrically conductive
- Lining: Special rubber film, textile inserts, two crossed copper strands, steel wire spirals galvanised
- Cover: EPDM, black, electrically conductive, wear-resistant, weather-resistant, material impression
- Identification: continuous text label, blue/white: "SEMPERIT S Resist-U Chemie UPEL" and continuous raised imprint: "SEMPERIT S UPEL EN 12115:1999 UPEL SD (DN) PN 16 Ohm Quartal/LK"

Area of application: Chemical hose

Reinforcement: Special rubber film, textile lining, steel-wire spirals, copper strand

Material: Core: UPE, cover: EPDM

Length: 40 m

Norm: EN 12115:1999, TRbF 131/2:1992

Temperature range: ca. -35 °C to ca. +100 °C

Colour: black

Item No.	Inner diameter mm	Wall thickness mm	Outer diameter mm	Operating pressure bar / 20 °C	Vacuum bar / 20 °C	Bending radius mm
1082130	19	6	31	16	0.9	190
1082140	25	6	37	16	0.9	225
1082150	32	6	44	16	0.9	265
1082160	38	6.5	51	16	0.9	340
1082170	50	8	66	16	0.9	415
1082190	75	8	91	16	0.9	525
1082200	100	8	116	16	0.9	675

CHEMICAL HOSES

SEMPERIT 

Chemical hose RESIST E EPDM®

Chemical hose suitable as a fill and dispensing hose in the chemical and raw material extraction industries for suction and pressure loads.

Resistant to hot water, washwater, non-oxidising acids and bases.

- Temperature range: The core, depending on the flow medium up to +95°C, hose flexible down to -35°C, steam cleaning pressure-less up to 130°C / max. 30min
- Safety factor: 4 : 1
- Core: EPDM, black, smooth, electrically conductive
- Lining: Textile inserts, two crossed copper strands, steel wire spirals galvanised
- cover: EPDM, black, electrically conductive, wear-resistant, weather-resistant, material impression
- Identification: continuous banner, purple:
"SEMPERIT S Resist-E Chemie EPDM" and continuous raised imprint:
"SEMPERIT S EN 12115 EPDM SD (DN) PN 16 bar Ohm Quartal/JahrTRbF 131/2"



Area of application:	Chemical hose
Reinforcement:	Textile lining, steel-wire spirals, copper strand
Material:	EPDM
Length:	40 m
Norm:	EN 12115:1999, TRbF 131/2:1992
Temperature range:	ca. -35°C to ca. +95°C
Colour:	black

Item No.	Inner diameter mm	Wall thickness mm	Outer diameter mm	Operating pressure bar / 20 °C	Vacuum bar / 20 °C	Bending radius mm
1082230	19	6	31	16	0.9	125
1082240	25	6	37	16	0.9	150
1082250	32	6	44	16	0.9	175
1082260	38	6.5	51	16	0.9	225
1082270	50	8	66	16	0.9	275
1082290	75	8	91	16	0.9	350
1082300	100	8	116	16	0.9	450

CHEMICAL HOSES

Chemical hose FEP



Universal chemical hose with seamless inner layer made of FEP.

Suitable for most media except for chlorine trifluoride, oxygen difluoride and molten alkali metals. Limited resistance (20 °C) for chlorine and fluorine, gaseous.

- Temperature range: The core, depending on the flow medium -30 °C to +100 °C, steam cleaning pressureless up to 150 °C / max. 30 min
- Core: FEP, transparent, smooth, seamless
- Lining: Textile inserts, two crossed copper strands, steel wire spirals galvanised
- Cover: EPDM, grey (beginning at NW 63 black), electrically conductive, wear-resistant, weather and ageing resistant, non-flammable, material impression
- Identification: continuous text label, blue/white/red: FEP SD PN 16 100 °C R<10 hoch 6 Ohm TRbF 131 M EN 12115"

Area of application:	Chemical hose
Reinforcement:	Textile lining, steel-wire spirals, copper strand
Material:	Core: FEP, cover: EPDM
Length:	40 m
Norm:	EN 12115:1999, TRbF 131/2:1992
Temperature range:	ca. -30 °C to ca. +100 °C
Colour:	Core: transparent, cover: grey (beginning at NW 63 black)

Item No.	Inner diameter mm	Wall thickness mm	Outer diameter mm	Operating pressure bar / 20 °C	Vacuum bar / 20 °C	Bending radius mm
10025658	19	6	31	16	0.9	80
1109980	25	6	37	16	0.9	100
1110010	32	6	44	16	0.9	120
1110080	38	6.5	51	16	0.9	150
1110090	50	8	66	16	0.9	200

STEAM HOSES

Steam hose REIFF DampfFLEX

Steam hose for conveying saturated steam for cleaning and sterilisation applications.

Area of application:	Steam hose
Reinforcement:	Textile lining
Material:	EPDM
Length:	40 m
Temperature range:	ca. -30 °C to +95 °C (hot water) to +164 °C (saturated steam)
Colour:	black



Item No.	Inner diameter mm	Wall thickness mm	Outer diameter mm	Operating pressure bar / 164 °C (saturated steam)
190190	13	5	23	6
10015903	19	7	33	6
190220	25	7	39	6
190230	32	7.5	47	6
190240	38	9	56	6
190250	50	9	68	6

High-pressure steam hose

High-pressure steam hose for conveying saturated steam for cleaning and sterilisation applications.

Area of application:	High-pressure steam hose
Reinforcement:	Steel wire lining
Material:	Rubber
Length:	40 m
Norm:	EN ISO 6134:2005 Type 2/A
Temperature range:	ca. -40 °C to +210 °C (saturated steam)
Colour:	black



Item No.	Inner diameter mm	Wall thickness mm	Outer diameter mm	Operating pressure bar / 210 °C (saturated steam)
190260	13	6	25	18
190280	19	7	33	18
190290	25	7.5	40	18
190300	32	8	48	18
190310	38	8	54	18
190320	51	9	69	18

STEAM HOSES

Steam hose DS 1®



Steam hose for conveying saturated steam and hot water.

Successfully tested and used throughout the chemical industry.

- Safety factor: Steam 10 : 1, water 3.15 : 1
- Core: EPDM, black, smooth, electrically conductive
- Lining: Steel wire lining, braided, galvanised
- cover: EPDM, black, electrically conducting, material impression
- Identification: continuous text label, red:
"SEMPERIT S DS1 Sattedampf/Saturated Steam 210°C Sempersteam PN 18 bar R < 10 hoch 6 Ohm" and opposite, red-underlined impression according to EN ISO 6134 (for EN dimensions)

Area of application:	Steam hose
Reinforcement:	Steel wire lining
Material:	EPDM
Length:	40 m
Norm:	EN ISO 6134:2005
Temperature range:	up to +120°C (hot water), +210°C (saturated steam)
Colour:	black

Item No.	Inner diameter mm	Wall thickness mm	Outer diameter mm	Operating pressure bar / 210°C (saturated steam), bar / 120°C (hot water)	Bending radius mm
1110140	13	6	25	18.55	80
1110150	19	7	33	18.55	110
1110160	25	7.5	40	18.55	180
1110170	32	8	48	18.55	250
1110180	38	8	54	18.55	300
1110190	50	9	68	18.55	420

FLAT HOSES

Construction and industrial hose

Endless woven hose made of high-strength synthetic fibres with internal rubber lining

Area of application:	Construction and industrial hose
Design:	Products in open length, no fittings
Reinforcement:	Textile braiding
Material:	inner: rubber, outer: synthetic fabric
Colour:	white



Item No.	Nominal dimension	Inner diameter mm	Operating pressure bar / 20 °C
498530	D-25	25	8
588670	C-52	52	12
588680	B-75	75	12
190600	A-102	102	8
472880	A-110	110	8

Construction and industrial hose complete with installed with Storz couplings

Endless woven hose made of high-strength synthetic fibres with internal rubber lining
Complete with installed Storz couplings.

Area of application:	Construction and industrial hose
Design:	Completely installed
Reinforcement:	Textile braiding
Material:	inner: rubber, outer: synthetic fabric
Colour:	white



Item No.	Nominal dimension	Inner diameter mm	Length m	Operating pressure bar / 20 °C	Connection
190560	C-52	52	15	12	Both sides LM coupling C-52
190570	C-52	52	20	12	Both sides LM coupling C-52
190580	B-75	75	15	12	Both sides LM coupling B-75
190590	B-75	75	20	12	Both sides LM coupling B-75
190610	A-102	102	20	8	Both sides LM coupling A-102

CONVEYING HOSES

Sand blast hose SM 1®



Premium sand blast hose with unique core quality for conveying highly abrasive media such as quartz sand, steel shot, corundum, glass, etc.

Extremely long lifespan due to highly wear-resistant core quality.

Wear of the core on average is 36 mm³ (determined according to DIN ISO 4649:2006).

- Security against electrostatic charge build-up due to antistatic hose design
- Safety factor: 3.5 : 1
- Core: SBR/NR/BR, black, smooth, electrically conductive, highly wear-resistant
- Lining: Textile lining, wound
- Cover: SBR, black, antistatic, material impression
- Identification: continuous text label, yellow: "SEMPERIT S SM1® Sandstrahl-Shotblast Strahlmeister® PN 12 bar"

Area of application:	Sand blast hose
Reinforcement:	Textile lining
Material:	Core: SBR/NR/BR, cover: SBR
Length:	40 m
Norm:	EN ISO 3861:1997
Temperature range:	ca. -35 °C to ca. +80 °C
Colour:	black

Item No.	Inner diameter mm	Wall thickness mm	Outer diameter mm	Operating pressure bar / 20 °C	Bending radius mm
1110200	13	7	27	12	130
1110210	19	7	33	12	190
1110220	25	7	39	12	250
1110240	38	9	56	12	380
1110250	42	9	60	12	420

Sand blast hose SM 2®



Classical sand blast hose with excellent core quality for conveying highly abrasive media such as quartz sand, steel shot, corundum, glass, etc.

Very long lifespan due to highly wear-resistant core quality.

Wear of the core is less than 60 mm³ (determined according to DIN ISO 4649:2006).

- Security against electrostatic charge build-up due to antistatic hose design
- Safety factor: 3.5 : 1
- Core: NR/SBR/BR, black, smooth, antistatic, wear-resistant
- Lining: Textile lining, wound
- Cover: SBR, black, antistatic, material impression
- Identification: continuous text label, red: "SEMPERIT S SM2® Sandstrahl-Shotblast PN 12 bar"

Area of application:	Sand blast hose
Reinforcement:	Textile lining
Material:	Core: NR/SBR/BR, cover: SBR
Length:	40 m
Norm:	EN ISO 3861:1997
Temperature range:	ca. -35 °C to ca. +80 °C
Colour:	black

Item No.	Inner diameter mm	Wall thickness mm	Outer diameter mm	Operating pressure bar / 20 °C	Bending radius mm
759680	13	7	27	12	130
754690	19	7	33	12	190
188760	25	7	39	12	250
188770	32	8	48	12	320
188780	38	9	56	12	380

CONVEYING HOSES

Cement silo hose

Cement conveying hose for cement, powdered lime and other abrasive media.
Wear of the core on average is 90-110 mm³ according to DIN 53516.
Electrical resistance < 10 Exp 6 Ohm/m.

Area of application: Cement silo hose
Reinforcement: Textile lining, copper strand
Material: Core: NR/SBR, cover: SBR
Length: 20 m / 40 m
Temperature range: ca. -30 °C to ca. +80 °C
Colour: black



Item No.	Inner diameter mm	Wall thickness mm	Outer diameter mm	Operating pressure bar / 20 °C	Bending radius mm
597860	102	10	122	8	612

Food-silo hose

Food conveying hose for sugar, powder, feed, grains and granulates.

Area of application: Food-silo hose
Reinforcement: Textile lining, copper strand
Material: Core: NR/SBR, cover: SBR
Length: 40 m
Temperature range: ca. -30 °C to ca. +80 °C
Colour: Core: bright Cover: black



Item No.	Inner diameter mm	Wall thickness mm	Outer diameter mm	Operating pressure bar / 20 °C	Bending radius mm
1046820	75	9	93	8	450
1065350	102	10	122	8	612

CONVEYOR HOSE SYSTEMS

Sigma conveying systems



Many of these Sigma System hoses are still being used today where steel piping would have had to be replaced many times over.

The big advantage of the Sigma hose system is primarily that the inner dimension of the hoses precisely match that of the pipelines.

The flow medium, regardless of whether hydraulically or pneumatically conveyed, can thus navigate the transition from steel pipe to hose system without turbulence or vice versa.

Turbulence in pipe and/or hose lines minimises the flow volume and also increases abrasion significantly.

Simple to install, problem-free mounting

- No special design required
- No special tool needed to correctly install
- Operationally safe due to mating shape of flange coupling and hose

Lone lifespan, high quality standard

- Rubber against steel: up to 10x the lifespan of the line
- Wear layer tailored to the material being conveyed
- Quality control performed throughout the entire production process

No needless downtime, high economic value

- Thanks to the modular design, flexibility in use

- Easy to combine with existing systems
- Maximum conveying capacity – minimum retrofit times

Problem-free location change, no storage costs

- Reusable couplings
- Express replacement parts service
- Quick exchange of all required hose lengths

Maintenance-free, long-term operation

- Permanent maximum capacity with correctly selected materials
- Regular visual inspections are sufficient
- Use in open air does not require any protective paint coatings

Design and technical features of the SIGMA conveying hose

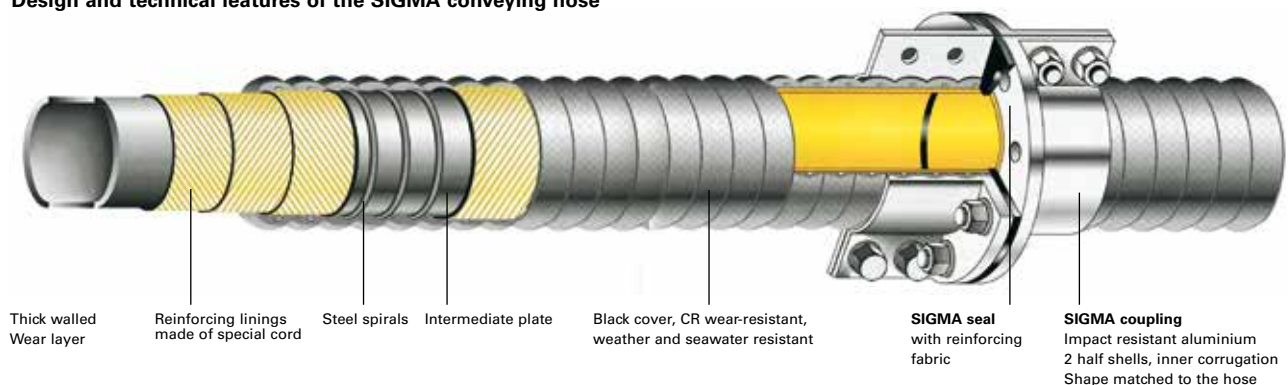

The design guarantees form stability both during pressure and during suction and gravity feeding.

Operating pressure: max. 10 bar.

Safety factor: 3.2:1 (bursting pressure min. 32 bar),

Vacuum: max. 9 mWS

Standard: Flange in DIN PN 10 and ASA 150 designs

Available on request:

Other flange designs, plastic-coated couplings (protection against corrosion and chemical attack).

The flange consists of two halves with inner corrugation, which is matched in shape to the surface of the hose. This causes the connection flange, designed according to DIN 2576, to not come into contact with the media at all and thus not be subject to any wear. The hoses are manufactured with thick cores exactly matched to the respective conveyed medium. For hydraulic conveying of abrasive materials suspended in water, we use a highly elastic wear-resistant, beige natural rubber core. For pneumatic conveying, such as sand, cement, lime, phosphate, broken glass, graphite dust, etc., we use a highly wear-resistant, black, electrically conductive core mixture. For the transport of chemicals and other aggressive media, other core mixtures are available, such as CSM, NBR white or EPDM.

CONVEYOR HOSE SYSTEMS

SEMPERIT

Sigma conveying systems

Your problem: Type of conveyance and medium

Hydraulic transport of abrasive materials such as lime, bauxite, corundum, dolomite, ore, feldspar, glass, wood shavings, industrial waste, coal, metal dust, nitrate, polishing media, quartz sand, carbon black, salt, clay granulate, uranium, tungsten, cement, gravel, mud, chalk, concrete, etc.

Pneumatic transport of abrasive materials such as cement, casting sand, phosphate, quartzite, dolomite, ground glass, dry mixed feed, grains, cocoa beans, bark, wood shavings, dust in vacuum systems etc.

Hydraulic transport of chemically aggressive materials, especially acids and bases according to the list of resistance values. For questions regarding resistance, etc., we are always available.

Pneumatic transport of solid and powdered foods, feeds, silo products, grains, bright plastic granulates, aggregates, and oil-containing materials, etc.

Hydraulic transport of abrasive materials in combination with chemically aggressive materials, (such as acids and bases according to the list of resistance values).

Our solution: Sigma conveying system

FS 3310

Pure natural rubber, light, wear-resistant and elastic; not electrically conducting; Hardness 40 ± 5 Shore A, temperature range $-35^{\circ}\text{C}/+70^{\circ}\text{C}$ Identification in red

FS 3320

Extremely wear-resistant NR/BR composite polymer, black, antistatic: Hardness 65 ± 5 Shore A, temperature range $-35^{\circ}\text{C}/+70^{\circ}\text{C}$ Identification in blue.

FS 3330

CSM, light, very resistant to inorganic acids; not electrically conductive; Hardness 55 ± 5 Shore A, temperature range $-35^{\circ}\text{C}/+95^{\circ}\text{C}$ Identification in green.

FS 3340

Special materials NBR/Semperline, white; Oil-resistant, wear-resistant, antistatic: hardness 60 ± 5 Shore A, temperature range $-35^{\circ}\text{C}/+80^{\circ}\text{C}$ Identification in white.

Coupling KU 3311

The number of holes can deviate from the information provided in the "Connection Dimensions" table depending on the design of the splitting flange. The correct splitting angle remains the same.

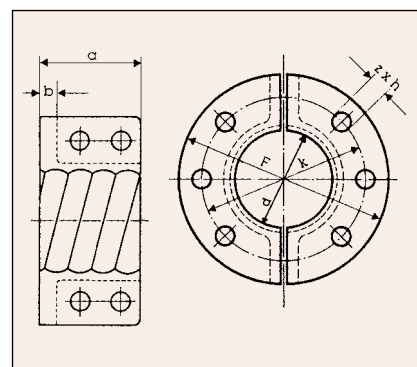

SIGMA – general data				1 Conveying hose FS 3310 – FS 3340				2 couplings KU 3311 & seals DI 3312							
								DIN EN 10 1092-1 (2576)				ASA 150			
Ø inner [mm] [inch]		L [m]	P* [O/–]	d _A [mm]	%s [mm]	R _{min} [m]	M [kg/m]	F _{DIN} [mm]	k _{DIN} [mm]	z _{DIN} x h _{DIN} [units] [mm]	F _{ASA} [inch]	k _{ASA} [inch]	z _{ASA} x h _{ASA} [units] [mm]		
51	2	40	O	75	5	0.3	3	165	125	8 x 18	4 ¾	6	8 x ¾		
63.5	2 ½	40	O	88	5	0.3	4	185	145	8 x 18	5 ½	7	8 x ¾		
76	3	40	O	114	11	0.35	8	200	160	8 x 18	6	7 ½	8 x ¾		
82	3 ¼	40	O	114	8	0.4	7	200	160	8 x 18					
90	3 ½	40	O	133	12	0.5	9.6	220	180	8 x 18	7	8 ½	8 x ¾		
102	4	40	O	133	7	0.5	8	220	180	8 x 18	7 ½	9	8 x ¾		
127	5	20	O	162	7	0.65	12.4	250	210	8 x 18	8 ½	10	8 x 7/8		
152	6	20	O	188	7	0.75	14.3	285	240	8 x 22	9 ½	11	8 x 7/8		
178	7	12	–	215	8	1.2	17.2	315	270	8 x 22					
203	8	12	–	241	8.5	1.75	18.8	340	295	8 x 22	11 ¾	13 ½	8 x 7/8		
254	10	12	–	292	8.5	2	22.6	395	350	12 x 22	14 ¼	16	12 x 1		
305	12	12	–	348	8.5	2.5	29	445	400	12 x 22	17	19	12 x 1		
355	14	12	–	409	12	3	40.8	505	460	16 x 22	18 ¾	21	16 x 1 1/8		
405	16	12	–	458	11	3.5	47	565	515	16 x 26	21 ¼	23 ½	16 x 1 1/8		
457	18	12	–	512	10	4.5	52.5	615	565	20 x 26					

GAS HOSES

Autogenous hose REIFF AutogenFLEX



Area of application: Autogenous hose
Reinforcement: Textile lining
Material: Rubber
Length: 40 m
Norm: EN 559
Temperature range: up to ca. +60°C
Colour: Core: black, cover: blue for oxygen/ red for acetylene gas

Item No.	Design	Inner diameter mm	Wall thickness mm	Outer diameter mm	Operating pressure bar / 20 °C	Colour
189250	for oxygen	6.3	3.5	13.3	20	blue
187380	for acetylene gas	6	3.5	13	20	red
187390	for oxygen	6.3	5	16.3	20	blue
187400	for acetylene gas	9	3.5	16	20	red

Autogenous hose TRIX®

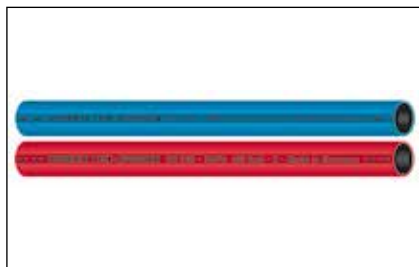

Autogenous hose with German brand quality, highly flexible, robust, kink-proof and stable shape, cover not sensitive to ozone, weathering and UV radiation, wear resistant

Area of application: Autogenous hose
Reinforcement: Textile lining
Material: EPDM
Length: 40 m
Norm: EN 559
Temperature range: up to ca. +60°C
Colour: Core: black, cover: blue for oxygen/ red for acetylene gas

Item No.	Design	Inner diameter mm	Wall thickness mm	Outer diameter mm	Operating pressure bar / 20 °C	Colour
187300	for oxygen	4	3.5	11	20	blue
189200	for acetylene gas	4	3.5	11	20	red
187320	for oxygen	6.3	3.5	13.3	20	blue
405800	for acetylene gas	6.3	3.5	13.3	20	red
187330	for oxygen	6.3	5	16.3	20	blue
187340	for acetylene gas	9	3.5	16	20	red

GAS HOSES

Autogenous twin hose

Area of application:	Autogenous hose
Design:	Twin hose
Reinforcement:	Textile lining
Material:	Rubber
Length:	40 m
Norm:	EN 559
Temperature range:	up to ca. +60 °C
Colour:	Core: black, cover: blue for oxygen/ red for acetylene gas

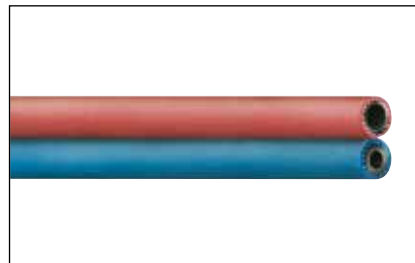

Item No.	Design	Inner diameter mm	Wall thickness mm	Outer diameter mm	Operating pressure bar / 20 °C
843790	for oxygen / acetylene gas	6 / 6	3.5 / 3.5	13 / 13	20
187410	for oxygen / acetylene gas	6 / 9	5 / 3.5	16 / 16	20

Propane gas hose

Area of application:	Propane gas hose
Reinforcement:	Textile lining
Material:	Core: NBR, cover: PVC/NBR
Length:	40 m
Norm:	DIN 4815/Part 1
Temperature range:	ca. -30 °C to ca. +70 °C
Colour:	Core: black, cover : orange



Item No.	Inner diameter mm	Wall thickness mm	Outer diameter mm	Operating pressure bar / 20 °C
187530	4	4	12	30
187540	6.3	3.5	13.3	6
377190	6.3	5	16.3	30
187560	9.5	3.5	16.5	6

Universal fuel gas hose TRIX®

Universal fuel gas hose

- highly flexible, robust, kink-proof and form-stable
- cover: not sensitive to ozone, weathering and UV radiation, wear resistant

Area of application:	Universal fuel gas hose
Reinforcement:	Textile lining
Material:	NBR
Length:	40 m
Norm:	EN 559
Temperature range:	up to ca. +60 °C
Colour:	Core: black, cover : red-orange

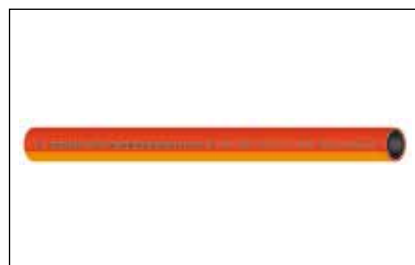

Item No.	Inner diameter mm	Wall thickness mm	Outer diameter mm	Operating pressure bar / 20 °C	Bending radius mm
1109920	6.3	3.5	13.3	20	30
1109930	9	3.5	16	20	45
1109940	11	3.8	18.6	20	55
1109960	12.5	4.5	21.5	20	60
1109970	16	4.5	25	20	80

EXPANSION JOINTS AND CORRUGATED HOSES



PTFE corrugated hoses

Based on the excellent physical and chemical properties of PTFE, PTFE corrugated hoses are used in the chemical, pharmaceutical and food industries. The hoses are also used in machine design and systems design due to their flexibility and fatigue resistance under severe installed situations and periodic movements.

Delivery variations:

PTFE white (standard) and PTFE black (antistatic), both in FDA quality. For reinforcement, the hoses can be equipped with twine spirals, wire spirals stainless steel braiding or PBT (plastic) braiding.

Temperature range of ca. -40°C to ca. +120°C (for PBT braiding), ca. -60°C to ca. +260°C (for stainless steel braiding). Technical specifications depend on design.

PTFE corrugated hoses are ready to install, equipped with connection fittings as delivered.



Rubber expansion joints

Rubber expansion joints are used in heating systems, industrial steam, hot water and hot air systems. They are low-noise-emitting and reduce pump, engine, compressor and turbine vibrations.

Delivery variations:

NBR yellow: for fuel and cooling water with mineral-based corrosion protection

CSM green: for aggressive acids, bases and other chemicals

EPDM red: for hot water and hot air

Butyl/EPDM red: for drinking water, service water, acids, bases, salt solutions and technical alcohols.

Standard nominal diameters DN 32 – DN 1000, standard design lengths 130–300 mm.

Operating pressure 10 or 16 bar. Flanges can be selected based on material (such as galvanised steel, stainless steel or aluminium) and connection dimensions (such as DIN, ANSI, BS or JIS) and other criteria (such as tie rods). Technical data depends on the respective design.



Metal expansion joints

Metal expansion joints for the flexible connection of pipelines of all types.

To compensate for thermal expansion in pipeline systems, to compensate for alignment deviations during installation in pipeline networks and to provide decoupling from vibrating pipeline networks.

Delivery variations:

Axial, lateral or angular expansion joints made of stainless steel 1.4541 or 1.4571 in single-walled or multi-walled design; with flanges, welded ends or threaded connections of various materials.

Standard nominal diameters DN 15 – DN 300

Temperature range ca. -200°C to ca. +600°C

Operating pressure up to ca. 100 bar

Technical data depends on the respective design.



Metal hoses

Metal hoses for highly flexible and permanently sealed lines for conveying liquids, gases, pumpable solids and to absorb vibrations and oscillations.

Delivery variations:

Metal hoses in single or multiple walled design in materials 1.4404, 1.4541, 1.4571 with braided wire of 1.4301.

Standard nominal diameters DN 4 – DN 350

Temperature range ca. -200°C to ca. +600°C

Operating pressure up to ca. 200 bar

Technical data depends on the respective design.

FOODSTUFF HOSES



Beer and beverage hose PURPURSCHLANGE®

Brand-name hose for use in breweries, wine press houses, dispensing facilities and other facilities in the brewing, beverage and liquor industries.

The light inner layer is absolutely odour-neutral and taste-neutral, homogeneous, smooth and free of plasticisers.

Flexibility, pressure resistant and long lifespan even under extreme conditions are further advantages that have given this hose an excellent international reputation.

- CIP cleaning possible
- Core: CIIR, white, pore-free, smooth
- printing media: synthetic yarns
- cover: CR/SBR/NR, not sensitive to ozone, weathering and UV radiation
- wear-resistant
- can be steamed up to +130 °C (max. 30 minutes), pressure-less
- tested by TU Munich, Weihenstephan (sensory test)

Area of application:	Beer and beverage hose
Reinforcement:	Textile lining
Material:	Core: CIIR, cover: CR/SBR/NR
Length:	40 m
Temperature range:	up to ca. +85 °C
Colour:	Core: light, cover: red with blue wave lines

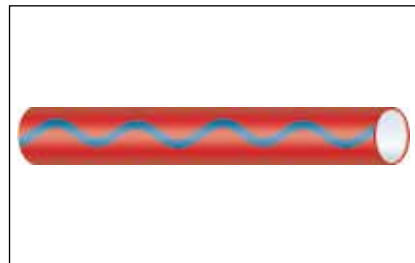

Item No.	Inner diameter mm	Wall thickness mm	Outer diameter mm	Operating pressure bar / 20 °C	Bending radius mm
478460	13	3.5	20	16	80
193500	19	5	29	16	120
193510	25	6	37	16	160
193520	32	8	48	16	200
1067800	38	9	56	16	240
193540	40	9	58	16	250
193550	50	10	70	16	310
193570	65	12	89	16	400
193590	80	14	108	16	500
193600	100	15	130	16	680

FOODSTUFF HOSES

Beer and beverage hose LM 1-EPDM®



Flexible hose for pressure applications in beer brewing and in the food and beverage industry.

For transporting alcoholic (max. 40 %) and non-alcoholic beverages and non-fat and fat-containing (max. 36 %) foods.

Neutral taste, odourless, kink-proof and robust

- temperature range: -35 °C / +95 °C, steam cleaning up to max. 130 °C / 30 min, pressure-less
- safety factor: 3.15 : 1
- Core: EPDM, white, smooth, food-compatible
- lining: Textile lining, wound
- Cover: SBR/NR/EPDM, red, wear, ozone and weather-resistant, material impression
- Identification: continuous text label, white: "SEMPERIT LM1-EPDM Brewer/Kellermeister D PN 12 bar"

Area of application: Beer and beverage hose

Reinforcement: Textile lining

Material: Core: EPDM, cover: SBR/NR/EPDM

Length: 40 m

Norm: BfR XXI:2002 (Cat. 2), FDA (CFR 21 § 177.2600), Weihenstephan

Temperature range: ca. -35 °C to ca. +95 °C

Colour: Core: light, cover: red

Item No.	Inner diameter mm	Wall thickness mm	Outer diameter mm	Operating pressure bar / 20 °C	Vacuum bar / 20 °C	Bending radius mm
1103260	25	6	37	12	0.5	150
1103270	32	8	48	12	0.5	170
1103280	40	10	60	12	0.5	250
1103290	50	11	72	12	0.5	350
1103300	65	12	89	12	0.4	450
1103310	80	15	110	12	0.3	650
1103320	100	15	130	12	0.2	750

FOODSTUFF HOSES

SEMPERIT 

Beverage and milk hose LM4S / Semperflex 1500®

Flexible spiral hoses subject to suction and pressure for loading and unloading of fatty foods.

Useful for animal and plant oils and fats.

Product hose for use in the food and drink industry for transporting milk and dairy products.

Not suitable for dry conveying.

- Temperature range: -35°C / +80°C, steam cleaning up to max. 130°C / 30 min, pressure-less
- Safety factor: 3.15 : 1
- Core: NBR, white, smooth, compatible for food, resistant to grease and oil
- Lining: Textile linings, braided, beginning at NW 65 wound; steel wire spirals, galvanised
- cover: NVC, blue, wear-resistant, aging-resistant, material impression
- Identification: continuous text label, white: "SEMPERIT S LM4S/SF 1500 – NBR Lebensmittel/Fatty Goods SD PN 10 bar"



Area of application:	Beverage and milk hose
Reinforcement:	Textile lining, steel-wire spirals
Material:	Core: NBR, cover: NVC
Length:	40 m
Norm:	BfR XXI:2002 (Cat. 2), FDA (CFR 21 § 177.2600)
Temperature range:	ca. -35°C to ca. +80°C
Colour:	Core: bright, Cover: blue

Item No.	Inner diameter mm	Wall thickness mm	Outer diameter mm	Operating pressure bar / 20 °C	Vacuum bar / 20 °C	Bending radius
1110550	25	6	37	10	0.9	85
1110560	32	6	44	10	0.9	105
1110570	38	6.5	51	10	0.9	120
1110580	40	7	54	10	0.9	140
1110590	50	7	64	10	0.9	160
1110600	65	7	79	10	0.9	210
1110610	80	8	96	10	0.9	260

FOODSTUFF HOSES

Milk collection truck hose CITERDIAL®



Flexible milk hose for conveying and dispensing milk, for milk collection tanks and stationary facilities.

- Cover is weather-resistant and wear-resistant
- smooth, seamless Core counteracts microbe build-up
- Steam-cleaning with max. 110 °C / max. 10 min, pressure-less

Area of application: Milk collection truck hose
Reinforcement: Textile lining, steel-wire spirals
Material: NR
Length: 40 m
Norm: BfR XXI (Cat. 3), FDA
Temperature range: ca. -30 °C to ca. +80 °C
Colour: Core: bright, Cover: blue

Item No.	Inner diameter mm	Wall thickness mm	Outer diameter mm	Operating pressure bar / 20 °C	Vacuum bar / 20 °C	Bending radius mm
1062990	25	5.5	36	6	0.9	50
1063000	38	5.5	49	6	0.9	76
1063010	40	5.5	51	6	0.9	80
1063020	45	5.5	56	6	0.9	90
1063030	51	6	63	6	0.9	102
1063040	53	6	65	6	0.9	106
1063050	60	6	72	6	0.9	120
1063060	63	6	75	6	0.9	126
10027468	70	6.75	83.5	6	0.9	140

Milk collection truck hose LACTADIAL®



Flexible milk hose for conveying and dispensing milk, for milk collection tanks and stationary facilities.

- Cover is weather-resistant and wear-resistant
- smooth, seamless Core counteracts microbe build-up
- Steam-cleaning with max. 110 °C / max. 10 min, pressure-less

Area of application: Milk collection truck hose
Reinforcement: Textile lining, PET spirals
Material: NR
Length: 40m
Norm: FDA (CFR 21 § 177.2600)
Temperature range: ca. -30 °C to ca. +80 °C
Colour: Core: bright, Cover: blue

Item No.	Inner diameter mm	Wall thickness mm	Outer diameter mm	Operating pressure bar / 20 °C	Vacuum bar / 20 °C	Bending radius mm
10087405	51	7	65	6	0.7	150
10087407	53	7	67	6	0.7	180
10087408	63	7	77	6	0.7	200
10087410	76	8	92	6	0.7	250

FOODSTUFF HOSES



Foodstuff hose LACTOPAL®

High-class multi-purpose hose for the food, pharmaceutical and cosmetic industries. The bright inner layer, which is also resistant to products containing grease and oil, is homogeneous, smooth, and neutral to taste and odour. It is resistant to the usual cleansers and disinfectants. The hose was designed extremely robust for rough every-day conditions, and is stable in form and can be driven over.

Area of application:	Foodstuff hose
Reinforcement:	Textile lining
Material:	Core: NBR, cover: NBR
Length:	40 m
Norm:	BfR XXI:2002, FDA, Weihenstephan
Temperature range:	up to ca. 80 °C
Colour:	Core: bright, cover: blue with red wave line



Item No.	Inner diameter mm	Wall thickness mm	Outer diameter mm	Operating pressure bar / 20 °C	Vacuum bar / 20 °C	Bending radius mm
10077186	13	4	21	16	0.7	80
10077187	16	4	24	16	0.7	100
10077188	19	5	29	16	0.7	115
10077189	25	6	37	16	0.5	150
10077190	32	8	48	16	0.5	195
10052806	38	9	56	16	0.5	230
10077194	40	9	58	16	0.5	240
10077196	50	10	70	16	0.5	300
10077198	60	10	80	16	0.5	420
10077202	65	12	89	16	0.5	455
10077208	75	12	99	16	0.45	525
10077209	80	14	108	16	0.45	560
10077211	100	15	130	16	0.45	700

FOODSTUFF HOSES

Foodstuff hose LACTOPAL®L

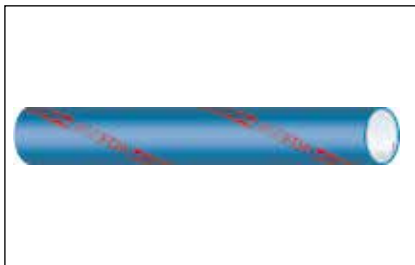

High-class multi-purpose hose for the food, pharmaceutical and cosmetic industries. The bright inner layer, which is also resistant to products containing grease and oil, is homogeneous, smooth, and neutral to taste and odour. It is resistant to the usual cleansers and disinfectants. The integral wound steel wire makes the hose flexible, light and particularly strong against suction.

Area of application: Foodstuff hose
Reinforcement: Textile lining, steel-wire spirals
Material: Core: NBR, cover: NBR
Length: 40 m
Norm: BfR XXI:2002, FDA, Weihenstephan
Temperature range: up to ca. 80 °C
Colour: Core: bright, cover: blue with red wave line

Item No.	Inner diameter mm	Wall thickness mm	Outer diameter mm	Operating pressure bar / 20 °C	Vacuum bar / 20 °C	Bending radius mm
10092798	19	5	29	16	0.8	60
10092799	25	6	37	16	0.8	80
10092800	32	6	44	16	0.8	100
10092801	38	6.5	51	16	0.8	115
10092802	40	7	54	16	0.8	130
10049465	50	8	66	16	0.8	150
10092803	53	7	67	16	0.8	160
10092805	60	7	74	16	0.8	170
10092806	63	7	77	16	0.8	180
10092809	65	8	81	16	0.8	190
4169160	75	8	91	16	0.8	225
10092817	80	8	96	16	0.8	300
10092819	100	9	118	16	0.8	350

FOODSTUFF HOSES

SEMPERIT 

Food and dairy steam hose LM 3®

For cleaning needs in creameries, food processing plants and slaughterhouses.

Useful as steam, hot water and cold water hoses.

To convey fluid foods, especially milk and dairy products and animal and plant oils and fats.

- Temperature range: -35 °C / +95 °C hot water/ +164 °C saturated steam
- Safety factor: Steam: 10 : 1, hot water: 3.15 : 1
- Core: NBR, white, smooth, compatible for food, resistant to grease and oil
- Lining: Textile lining, wound
- Cover: NVC, blue, oil-resistant, material impression
- Identification: continuous text label, white: "SEMPERIT S LM3 – NBR Lebensmittel/ Dampf/Food/Steam D PN 6 bar 164 °C Dampf"

Area of application: Food and dairy steam hose

Reinforcement: Textile lining

Material: Core: NBR, cover: NVC

Length: 40 m

Norm: BfR XXI:2002 (Cat. 2), FDA (CFR 21 § 177.2600)

Temperature range: ca. -35 °C to +95 °C (hot water) to +164 °C (saturated steam)

Colour: Core: bright, Cover: blue



Item No.	Inner diameter mm	Wall thickness mm	Outer diameter mm	Operating pressure bar / 164 °C (saturated steam), Bending radius bar / 95 °C (hot water),
1110460	13	5	23	6, 18
1110470	19	6	31	6, 18
1110480	25	7	39	6, 18
1110490	32	7	46	6, 18
1110500	38	9	56	6, 18
1110510	40	9	58	6, 18
1110520	50	10	70	6, 18
1110530	65	12	89	6, 18

Dairy steam hose REIFF MolkereiFLEX

To convey steam and hot water for cleaning purposes and to convey liquid foods such as milk.

For use in creameries, slaughterhouses and in the food industry.

- Temperature range: -35 °C / +95 °C (hot water)/ +164 °C (saturated steam)
- Safety factor: Steam: 10 : 1, hot water: 3.15 : 1
- Core: EPDM, white, smooth, compatible for food, temperature and cleanser resistant
- Lining: Textile lining, wound
- Cover: EPDM, blue, wear-resistant, grease and oil resistant, material impression

Area of application: Dairy steam hose

Reinforcement: Textile lining

Material: EPDM

Length: 40 m

Norm: BfR XXI:2002 (Cat. 2), FDA (CFR 21 § 177.2600)

Temperature range: ca. -35 °C to +95 °C (hot water) to +164 °C (saturated steam)

Colour: Core: bright, Cover: blue



Item No.	Inner diameter mm	Wall thickness mm	Outer diameter mm	Operating pressure bar / 164 °C (saturated steam), bar / 95 °C (hot water)	Bending radius mm
190330	13	6	25	6, 18	90
190340	19	6	31	6, 18	120

AIR HOSES



Compressed air hose REIFF PressluftFLEX

Pressure hose for conveying oily compressed air and water.

Area of application: Compressed air hose
Reinforcement: Textile lining
Length: 40 m
Temperature range: ca. -10 °C to ca. +70 °C
Colour: black



Item No.	Inner diameter mm	Wall thickness mm	Outer diameter mm	Operating pressure bar / 20 °C
776090	6	3.5	13	15
776100	9	3.5	16	15
187710	10	3.5	17	15
187720	13	4	21	15
187740	19	5	29	15
187750	25	5.5	36	15

Compressed air hose TRIX-BLAUSTRAHL®

Compressed air hose for heavy-duty use in industry, mining, high-rise construction and excavation.

- Cover not sensitive to ozone, weathering and UV radiation, wear-resistant
- highly flexible and robust
- good oil resistance

Area of application: Compressed air hose
Reinforcement: Textile lining
Material: NBR
Length: 40 m
Norm: EN ISO 2398 Type 7 B
Temperature range: ca. -40 °C to ca. +70 °C
Colour: Core: black, cover: black with 6 blue axial stripes



Item No.	Inner diameter mm	Wall thickness mm	Outer diameter mm	Operating pressure bar / 20 °C	Bending radius mm
187600	10	5	20	25	50
187680	13	5	23	25	65
187610	13	6	25	25	65
187690	15	5	25	25	75
187620	15	6	27	25	75
187700	19	5	29	25	95
187630	19	6	31	25	95
187640	25	7	39	25	125
187650	28	8	44	16	170
187660	35	8	51	16	220
187670	42	9	60	16	330

AIR HOSES

Compressed air hose, yellow

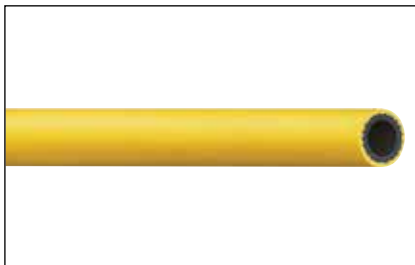

Pressure hose for conveying oily compressed air and water.

- robust, hard-wearing quality

Area of application:	Compressed air hose
Reinforcement:	Textile lining
Material:	Rubber
Length:	40 m
Temperature range:	ca. -20 °C to ca. +50 °C
Colour:	Core: black, cover : yellow

Item No.	Inner diameter mm	Wall thickness mm	Outer diameter mm	Operating pressure bar / 20 °C	Bending radius mm
876770	13	5	23	20	105
876780	19	6	31	20	150
876790	25	7	39	20	200

PVC fabric hose REIFF CristallFLEX



Area of application:	Compressed air fabric hose
Reinforcement:	Textile lining
Material:	PVC
Temperature range:	up to ca. +60 °C
Colour:	transparent

Item No.	Inner diameter mm	Wall thickness mm	Outer diameter mm	Length m	Operating pressure bar / 20 °C
765120	6	3	12	50	15
765130	8	3	14	50	15
765140	9	3	15	50	15
765150	10	3	16	50	15
1068140	12	3	18	50	12
777040	13	3	19	50	12
904130	16	3	22	50	10
816930	19	3.5	26	50	10
816940	25	4	33	25	8
816950	30	4	38	25	7
816970	32	5	42	25	7
816990	50	5	60	25	3

AIR HOSES



PVC fabric hose RAUFILAM-E®

Brand name, food-quality compressed air fabric hose.

- high reinforcement density, permanent transparency, appealing colour, nice flexibility, high resistance to chemicals and excellent ageing resistance
- Environmentally friendly, cadmium-free material

Area of application: Compressed air fabric hose
Reinforcement: Textile lining
Material: PVC
Temperature range: up to ca. +60 °C
Colour: transparent



Item No.	Inner diameter mm	Wall thickness mm	Outer diameter mm	Length m	Operating pressure bar / 20 °C	Bending radius mm
191450	6	3	12	50	20	25
191460	8	3	14	50	18	30
191470	9	3	15	50	16	35
191480	10	3	16	50	14	40
191490	12	3	18	50	14	55
457760	12.2	4.2	20.6	50	14	50
191500	13.2	3.3	19.8	50	12	70
191510	16.2	3.7	23.6	50	12	90
191520	19.4	3.7	26.8	50	10	130

Item No.	Inner diameter mm	Wall thickness mm	Outer diameter mm	Length m	Operating pressure bar / 20 °C	Bending radius mm
191530	25.4	4.3	34	25	8	200
191550	32.4	4.8	42	25	7	310
191560	38	4.8	47.6	25	6	420
191570	50	6	62	25	4	620

PVC compressed air hose RAUPASTAM®

Compressed air fabric hose with high pressure resistance, flexibility, low weight and small outer diameter.

Area of application: Compressed air fabric hose
Reinforcement: Textile lining
Material: PVC
Length: 50 m
Temperature range: ca. -10 °C to ca. +60 °C
Colour: Core: transparent, Cover: blue



Item No.	Inner diameter mm	Wall thickness mm	Outer diameter mm	Operating pressure bar / 20 °C	Bending radius mm
192010	4	1.1	6.2	40	50
192020	6	1.1	8.2	35	60
192030	9	1.3	11.6	30	70
192000	13	2.3	17.6	28	100

AIR HOSES

PUR pressure hose NORFLEX® PUR 441 MHF



Pressure hose

- for abrasive solids such as dusts, powders, fibres and chippings
- for gaseous and fluid media
- highly flexible
- very wear-resistant
- smooth interior and exterior
- high tensile and tear strength
- fabric-reinforced
- wall is food-compatible according to FDA 21 CFR 177.2600 and 178.2010, EC Guideline 2002/72/
- EC, including the most recent amended Guideline 2007/19/EC, German recommendation XXXIX BfR polyurethane
- odourless and tasteless
- resistant to microbes and hydrolysis
- good oil and petroleum resistance
- good chemical resistance
- good UV and ozone resistance
- very good flexibility in cold climates
- minimal bending radii
- free of plasticisers and halogens
- gas-tight and liquid-tight
- pressure resistant
- can be stepped on
- very robust

Area of application:	Pressure hose
Reinforcement:	Textile lining
Material:	Ether PUR
Length:	50 m
Temperature range:	ca. -40 °C to ca. +90 °C
Colour:	Natural-transparent

Item No.	Inner diameter mm	Wall thickness mm	Outer diameter mm	Operating pressure bar / 20 °C	Bending radius mm
10025871	2.9	1.4	5.7	20	15
10025873	4	2	8	20	15
10025874	6	2	10	16	25
10025875	8	2	12	16	30
10025876	10	2.25	14.5	12	60
10025877	13	3	19	10	85
10025879	19	3	25	8	125

AIR HOSES



Silicone pressure hose NORFLEX® SIL 448

Pressure hose

- for solids
- for gaseous and fluid media
- highly flexible
- smooth interior and exterior
- fabric-reinforced
- wall is food-compatible according to FDA 21 CFR Part 177.2600/BGW
- minimal bending radii
- gas-tight and liquid-tight
- pressure-resistant
- red: peroxide cross-linked
- blue: platinum cross-linked, odour-free and tasteless

Area of application: Pressure hose
Reinforcement: Textile lining
Material: Silicone
Length: 25 m
Temperature range: ca. -60 °C to ca. +180 °C



Item No.	Inner diameter mm	Wall thickness mm	Outer diameter mm	Operating pressure bar / 20 °C	Bending radius mm	Colour
10025880	3	2.5	8	16	25	red
10025881	3	2.5	8	16	25	blue
10025882	4	2.5	9	15	35	red
10025884	4	2.5	9	15	35	blue
10025885	5	3	11	13	35	red
10025886	5	3	11	13	35	blue
10025887	6	3	12	12	40	red
10025889	6	3	12	12	40	blue
10025891	8	3.2	14.4	10	45	red
10025894	8	3.2	14.4	10	45	blue
10025895	10	3.5	17	9	50	red
10025897	10	3.5	17	9	50	blue
10025898	13	3.5	20	8	70	red
10025900	13	3.5	20	8	70	blue
10025901	16	4.5	25	7	80	red
10025902	16	4.5	25	7	80	blue
10025903	19	4.5	28	6	90	red
10025904	19	4.5	28	6	90	blue

Brake hose

Brake hose for compressed air braking systems in motor vehicles.

- Cover wear-resistance, ageing and weather-resistant

Area of application: Compressed air brake hose
Reinforcement: Textile lining
Material: EPDM
Length: 40 m
Norm: DIN 74310
Temperature range: ca. -40 °C to ca. +70 °C
Colour: black



Item No.	Inner diameter mm	Wall thickness mm	Outer diameter mm	Operating pressure bar / 20 °C	Bending radius mm
4003900	11	3.5	18	10	70
187770	13	6	25	10	100

AIR HOSES



Hot air blower hose



Pressure hose for conveying dry hot air from the compressor to the tank.

Area of application: Hot air blower hose
Reinforcement: Textile lining
Material: Rubber
Length: 40 m
Temperature range: ca. -40 °C to ca. +180 °C
Colour: Core: bright Cover: black

Item No.	Inner diameter mm	Wall thickness mm	Outer diameter mm	Operating pressure bar / 20 °C
1024340	51	9	69	10
1065360	65	9	83	10
1067680	76	9	94	10

OIL AND FUEL HOSES



Tank truck hose without spirals

Pressure hose for mineral oil products with a maximum aromatics content of 50%.

- Cover antistatic ($R < 1$ Mega Ohm/m), wear-resistant, ageing and weather-resistant

Area of application:	Tank truck hose
Reinforcement:	Textile lining, copper strand
Material:	Core: NBR, cover: NBR/SBR
Length:	40 m
Norm:	EN 12115, TRbF 131/2 Section 5.5
Temperature range:	ca. -25 °C to ca. +80 °C
Colour:	black



Item No.	Inner diameter mm	Wall thickness mm	Outer diameter mm	Operating pressure bar / 20 °C	Bending radius mm
1068010	25	6	37	16	150
1068020	32	6	44	16	175
1068030	38	6.5	51	16	225
1068040	50	8	66	16	275
1068050	75	8	91	16	350

Tank truck hose with spirals

Suction and pressure hose for loading and unloading tank vehicles.

Suitable for mineral oil products with a maximum aromatics content of 50%.

- flexible with low bending forces
- cover is antistatic ($R < 1$ Mega Ohm/m), weather-resistant

Area of application:	Tank truck hose
Reinforcement:	Textile lining, steel-wire spirals, copper strand
Material:	Core: NBR, cover: NBR/SBR
Length:	40 m
Norm:	EN 12115, TRbF 131/2 Section 5.5
Temperature range:	ca. -25 °C to ca. +80 °C
Colour:	black



Item No.	Inner diameter mm	Wall thickness mm	Outer diameter mm	Operating pressure bar / 20 °C	Vacuum bar / 20 °C	Bending radius mm
568790	25	6	37	16	0.9	150
188270	32	6	44	16	0.9	175
188280	38	6.5	51	16	0.9	225
188300	50	8	66	16	0.9	275
1068100	75	8	91	16	0.9	350

OIL AND FUEL HOSES

Tank truck hose with spirals TM 1®



Robust suction and pressure hose, ideal for loading and unloading of tanks, tank vehicles and ships with unleaded fuels (EN228:2004) with an oxygen limit according to EEC 85/536 and an aromatics content of up to 50%.

Can be used for technical oils, Diesel oils (EN 590:2004), heating oils (DIN 51 603 Part 1 - 5), mineral-based hydraulic oils.

- Safety factor: 4 : 1
- Core: NBR, black, smooth, electrically conducting
- Lining: Textile lining, braided (NW > 3 inches, wound), two crossed copper strands, steel wire spirals, galvanised
- Cover: CR, black, electrically conductive, wear-resistant, oil and weather-resistant, material impression
- Identification: continuous banner, yellow: "SEMPERIT STM1 Mineralöl/Oil Tankmeister® 1 SD PN 16 bar R < 10 hoch 6 Ohm" and continuous raised impression according to EN 1761:1999 and EN 12115:1999

Area of application: Tank truck hose

Reinforcement: Textile lining, steel-wire spirals, copper strand

Material: Core: NBR, cover: CR

Length: 40 m

Norm: EN 1761:1999, EN 12115:1999, TRbF 131/2:1992

Temperature range: ca. -30 °C to ca. +90 °C

Colour: black

Item No.	Inner diameter mm	Wall thickness mm	Outer diameter mm	Operating pressure bar / 20 °C	Vacuum bar / 20 °C	Bending radius mm
1110020	25	6	37	16	0.9	150
1110030	32	6	44	16	0.9	175
1110040	38	6.5	51	16	0.9	225
1110050	50	8	66	16	0.9	275
1110060	75	8	91	16	0.9	350
1110070	100	8	116	16	0.9	450

OIL AND FUEL HOSES

SEMPERIT 

Tank truck hose with spirals TMSL®

Particularly robust suction and pressure hose for loading and unloading of tank vehicles and rail cars with unleaded fuels (EN228:2004) with an oxygen limit according to EEC 85/536 and an aromatics content of up to 50%.

Can be used for technical oils, Diesel oils (EN 590:2004), heating oils (DIN 51 603 Part 1 - 5), mineral-based hydraulic oils.

Due to the elongation of the special spiral construction, we recommend that up to a max. of 6 bar be used for pressure operations, as for filling activities.

- Safety factor: 4 : 1
- Core: NBR, black, smooth, electrically conducting
- Lining: Textile lining, wound, copper strand, double steel wire spirals, galvanised
- Cover: CR, black, corrugated, electrically conductive, wear-resistant, oil and weather-resistant, material impression
- Identification: continuous banner, yellow: "SEMPERIT STMSL Mineralöl/Oil Tankmeister® – superleicht SD PN 10 bar R < 10 hoch 6 Ohm" and continuous embossed strip "STMSL Jahr PN 10 bar Ohm TRbF 131 / 2"



Area of application:	Tank truck hose
Reinforcement:	Textile lining, steel-wire spirals, copper strand
Material:	Core: NBR, cover: CR
Length:	40 m
Norm:	TRbF 131/2:1992
Temperature range:	ca. -30 °C to ca. +90 °C
Colour:	black

Item No.	Inner diameter mm	Wall thickness mm	Outer diameter mm	Operating pressure bar / 20 °C	Vacuum bar / 20 °C	Bending radius mm
817040	50	7.5	65	10	0.9	80
840030	75	7.5	90	10	0.9	100

HOSES WITHOUT REINFORCEMENT

PVC hose, glass clear



PVC Hoses without reinforcement for non-pressurized use.

Area of application: Multi-purpose hose
Material: PVC
Temperature range: up to ca. +60 °C
Colour: transparent

Item No.	Inner diameter mm	Wall thickness mm	Outer diameter mm	Length m
190640	2	1	4	100
190650	3	1	5	100
190660	3	1.5	6	100
190670	4	1	6	100
190680	4	1.5	7	100
190690	4	2	8	100
190700	5	1	7	100
190710	5	1.5	8	100
190720	5	2	9	100
190730	6	1	8	100
190740	6	1.5	9	100
190750	6	2	10	100
190780	7	1.5	10	100
190790	7	2	11	100
190800	8	1	10	100

Item No.	Inner diameter mm	Wall thickness mm	Outer diameter mm	Length m
190810	8	1.5	11	50
190820	8	2	12	50
190840	9	1.5	12	50
190850	9	2	13	50
190860	10	1.5	13	50
190870	10	2	14	50
190880	10	3	16	50
190890	12	2	16	50
190910	12	3	18	50
190930	13	2	17	50
190940	13	3	19	50
190950	14	2	18	50
190960	15	2	19	50
190970	15	3	21	50
190980	16	2	20	50
191000	16	3	22	50
191020	18	2	22	50
191030	18	3	24	50
191050	19	3	25	50
191060	19	3.5	26	50
191070	19	4	27	50
191090	20	2	24	50
191100	20	3	26	50
191110	22	3	28	50
191130	25	3	31	50
191140	25	4	33	50

Continued ➞

HOSES WITHOUT REINFORCEMENT

PVC hose, glass clear

Item No.	Inner diameter mm	Wall thickness mm	Outer diameter mm	Length m
191180	28	4	36	25
191190	30	4	38	25
191230	32	4	40	25
191270	35	3.5	42	25
191280	35	5	45	25
191290	38	5	48	25
191320	40	5	50	25
191350	50	5	60	25
191370	60	5	70	25

Polyamide hose

Compressed air hose with good chemical resistance against oils, greases, fuels, paint solvents and hydraulic liquids.

- low weight
- high impact resistance
- good resistance to stress-induced cracking
- good pressure resistance
- very good UV resistance
- high wear resistance
- not sensitive to water

Area of application: Pneumatic hose
Material: PA 11/12 w
Hardness: ca. 75 Rockwell
Temperature range: ca. -40 °C to ca. +90 °C



Item No.	Inner diameter mm	Wall thickness mm	Outer diameter mm	Operating pressure bar / 20 °C	Bending radius mm	Colour
411040	2	1.0	4	45	20	Natural colours
427900	3	1.0	5	35	25	Natural colours
411090	4	1.0	6	27	25	Natural colours
411080	6	1.0	8	19	30	Natural colours
411120	8	1.0	10	15	60	Natural colours
415670	9	1.5	12	19	60	Natural colours
213010	12	1.5	15	12	90	Natural colours

HOSES WITHOUT REINFORCEMENT

Polyamide coil tube



Compressed air coil tubes with good chemical resistance to oils and greases.

- low weight
- high pressure resistance
- high restoration force

Area of application: Pneumatic hose
Design: both sides, axial
Reinforcement: Threaded connection and kink-protection spring
Material: PA 11/12 w
Hardness: ca. 75 Rockwell
Temperature range: ca. -40 °C to ca. +90 °C

Item No.	Inner diameter mm	Wall thickness mm	Outer diameter mm	Working length m	Operating pressure bar / 20 °C	Connection	Colour
415680	6	1.0	8	4	19	Both sides 1/4"outer threads rotatable	blue
415690	6	1.0	8	8	19	Both sides 1/4"outer threads rotatable	blue

Polyurethane hose



Compressed air hose with good resistance to oils and greases

- low weight
- small bending radius
- high elasticity
- extremely flexible to cold
- good damping behaviour
- excellent wear-resistance
- excellent tear resistance
- UV resistant
- no embrittlement since there are no plasticisers

Area of application: Pneumatic hose
Material: PUR
Hardness: ca. 98 Shore A
Temperature range: ca. -40 °C to ca. +85 °C

Item No.	Inner diameter mm	Wall thickness mm	Outer diameter mm	Operating pressure bar / 20 °C	Bending radius mm	Colour
664410	4	1.0	6	14	30	natural
183980	4	1.0	6	14	30	blue
427920	4	1.0	6	14	30	black
184000	6	1.0	8	10	35	blue
427930	6	1.0	8	10	35	black
184020	8	1.0	10	7	50	blue

HOSES WITHOUT REINFORCEMENT

Polyethylene hose

Compressed air hose with good resistance against a number of chemicals.

- low weight
- physiologically compatible (meets recommendation III of the BGA and FDA Regulation 21 CFR 177.120 c 2.1)
- low permeation values for water, water vapour and gases
- sterilisable (ethylene oxide and gamma radiation)
- good dielectric characteristics

Area of application: Pneumatic hose
Material: LD-PE
Hardness: ca. 45 Shore D
Temperature range: ca. -30°C to ca. +70°C
Colour: Natural colours



Item No.	Inner diameter mm	Wall thickness mm	Outer diameter mm	Operating pressure bar / 20°C	Bending radius mm
191770	2	1.0	4	17	20
191790	4	1.0	6	10	30
191800	5	1.5	8	13	40
191810	6	1.0	8	7	30
191830	8	1.0	10	5.6	40
191840	9	1.5	12	8	60
191740	10	1.0	12	4.5	60
568770	10	2.0	14	8	80
191760	12	2.0	16	7	90

PTFE hose

Multi-purpose hose with excellent material properties.

- excellent lubricating and anti-adhesion properties
- high and wide range of temperature use
- very good universal chemical resistance
- no water absorption
- non-flammable
- good electrical and dielectric properties

Area of application: Multi-purpose hose
Material: PTFE
Hardness: ca. 55 Shore D
Temperature range: ca. -200°C to ca. +260°C
Colour: Natural colours



Item No.	Inner diameter mm	Wall thickness mm	Outer diameter mm	Operating pressure bar / 20°C	Bending radius mm
177670	4	1.0	6	12	36
464670	5	1.0	7	10	50
177680	6	1.0	8	8	65
177690	8	1.0	10	6	100
650630	10	1.0	12	5	145

HOSES WITHOUT REINFORCEMENT

Machine and fuel hose



Machine and fuel hose without lining

- for non-pressure use
- for mineral oils and fuels

Area of application: Machine and fuel hose
Design: no braiding
Material: NBR
Hardness: ca. 65 +/-5 Shore A
Temperature range: ca. -10 °C to ca. +80 °C
Colour: black

Item No.	Inner diameter mm	Wall thickness mm	Outer diameter mm
4024400	4	2.0	8
188550	5	1.5	8
188560	6	2.0	10
188580	7	2.0	11
188590	8	2.0	12
188600	10	2.0	14
188610	12	2.5	17

Barrel pump hose



Barrel pump hose without lining

- for mineral oils and fuels

Area of application: Barrel pump hose
Material: NBR
Hardness: ca. 70 +/-5 Shore A
Temperature range: ca. -10 °C to ca. +80 °C
Colour: black

Item No.	Inner diameter mm	Wall thickness mm	Outer diameter mm
188500	13	3	19
188510	16	3.5	23
188520	19	4	27
188530	25	4	33

HOSES WITHOUT REINFORCEMENT

Silicone hose without lining

Silicone hose without lining

- for non-pressure use
- talc-powdered
- applications in and on the body are not allowed!

Area of application: Multi-purpose hose

Material: Silicone

Hardness: ca. 60 Shore A

Norm: BfR XV and FDA 177.2600

Temperature range: up to ca. +180 °C

Colour: translucent



Item No.	Inner diameter mm	Wall thickness mm	Outer diameter mm
191850	1	1	3
191860	2	1	4
191870	3	1	5
1200520	3	1.5	6
191880	4	1	6
568180	4	2	8
191890	5	1.5	8
191900	6	1.5	9
191910	7	1.5	10
191920	8	2	12
191930	10	2.5	15
191940	12	2	16

MULTI PURPOSE HOSES

Multi-purpose hose REIFF UniversalFLEX 20



Multi-purpose hose in extruded design.

Suitable for mineral oil products with a maximum aromatics content of 40 %.

• cover is wear-resistant, weather and ageing resistant, antistatic ($R < 1 \text{ Mega Ohm/m}$)

Area of application: Multi-purpose hose
Reinforcement: Textile lining
Material: Core: NBR, cover: NBR/EPDM
Length: 40 m
Temperature range: ca. -20 °C to ca. +80 °C
Colour: black

Item No.	Inner diameter mm	Wall thickness mm	Outer diameter mm	Operating pressure bar / 20 °C	Bending radius mm
4025000	6	3.5	13	20	50
4025020	10	3.5	17	20	80
4025030	13	3.5	20	20	105
4025040	19	4	27	20	150
4025050	25	5	35	20	200

Multi-purpose hose REIFF UniversalFLEX 30



Multi-purpose hose in extruded design.

• Suitable for mineral oil products with a maximum aromatics content of 50 %.

• cover is self-extinguishing, wear-resistant and weather resistant, antistatic ($R < 1 \text{ Mega Ohm/m}$)

Area of application: Multi-purpose hose
Reinforcement: Textile lining
Material: Core: NBR, cover: CR
Length: 40 m
Temperature range: ca. -30 °C to ca. +100 °C
Colour: black

Item No.	Inner diameter mm	Wall thickness mm	Outer diameter mm	Operating pressure bar / 20 °C	Bending radius mm
4025080	10	3.5	17	30	70
4025090	13	4	21	30	90

MULTI PURPOSE HOSES

Multi-purpose suction and pressure hose REIFF OelspiralFLEX

Multi-purpose hose for suction and pressure uses.

- oil and petroleum resistant

Area of application:	Multi-purpose hose
Design:	corrugated on the outside
Reinforcement:	Textile lining, steel-wire spirals
Material:	Core: NBR, cover: CR
Length:	40 m
Temperature range:	ca. -36°C to ca. +80°C
Colour:	Core: black, cover: black with red Vulkanette



Item No.	Inner diameter mm	Wall thickness mm	Outer diameter mm	Operating pressure bar / 20 °C	Vacuum bar / 20 °C	Bending radius mm
652210	19	4	27	13	0.7	95
652220	25	4	33	13	0.7	125
652230	30	4	38	13	0.7	150
652240	32	4	40	13	0.7	160
652250	35	4	43	10	0.7	175
652260	38	4	46	10	0.7	190
794000	40	4	48	10	0.7	200
652270	50	5	60	10	0.7	250
652280	60	5	70	10	0.7	360
1137790	65	6	77	10	0.7	390
652290	75	5	85	10	0.7	450
1006810	90	7	104	10	0.7	540
958600	100	7	114	10	0.7	600

Multi-purpose suction and pressure hose REIFF SaugFLEX R4

Multi-purpose hose for suction and pressure uses.

Suitable as a hose for mineral oils in the industry and as an oil recycle hose for agricultural machinery.

Area of application:	Multi-purpose hose
Design:	externally smooth
Reinforcement:	Textile lining, steel-wire spirals
Material:	Core: NBR, cover: CR
Length:	40 m
Temperature range:	ca. -40°C to ca. +100°C
Colour:	Core: black, cover: black with red Vulkanette



Item No.	Inner diameter mm	Wall thickness mm	Outer diameter mm	Operating pressure bar / 20 °C	Vacuum bar / 20 °C	Bending radius mm
10084323	19	5	29	21	0.8	35
10084366	25.4	4.8	35	17	0.8	45
10084368	31.8	5.1	42	14	0.8	55
10084370	38.1	5.45	49	10	0.8	65
10084374	50.8	5.6	62	7	0.8	100
10084377	63.5	6	75.5	4	0.8	130
10084378	76.2	5.9	88	4	0.8	160
10084379	88.9	7.05	103	3	0.8	210
10084380	101.6	6.7	115	2	0.8	240

MULTI PURPOSE HOSES

Colour spray hose SOLVYKLER®

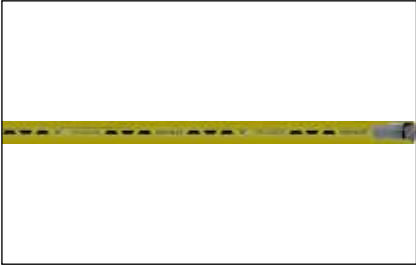

Colour spray hose for pressure conveying of ester, ketone or alcohol-based paints and numerous chemicals.

- electrically conducting core (R < 10 Exp 6 Ohm/m)
- silicone-free manufacture
- flexible and lightweight

Area of application: Colour spray hose
Reinforcement: Textile lining
Material: EPDM
Length: 40 m
Temperature range: ca. -30 °C to ca. +100 °C
Colour: Core: black, cover: olive green

Item No.	Inner diameter mm	Wall thickness mm	Outer diameter mm	Operating pressure bar / 20 °C	Bending radius mm
187780	6	3.5	13	20	60
187790	9	3.5	16	20	85
187810	13	4	21	20	110

WATER HOSES



Rubber drinking water hose AQUAPAL®

Rubber drinking water hose in German brand quality.

- special plastomeric inner layer, no plasticisers, homogeneous, smooth, absolutely odourless and neutral taste
- cover: wear resistant, UV, oil and grease resistant
- Identification: axial yellow, wave line on blue background with the text "AQUAPAL Trinkwasserschlauch PN 20 KTW „A“ und DVGW - W 270 geprüft"

Area of application: Drinking water hose
Reinforcement: Textile lining
Material: Core: Plastomer, cover: NBR
Length: 40 m
Norm: DVGW W 270, KTW Cat. „A“
Temperature range: ca. -20 °C to ca. +90 °C
Colour: Core: transparent, cover: blue with yellow wavy line



Item No.	Inner diameter mm	Wall thickness mm	Outer diameter mm	Operating pressure bar / 20 °C	Bending radius mm
4349180	13	3.6	20.2	20	75
10009144	16	3.6	23.2	20	95
4349190	19	4.2	27.4	20	110
4349200	25	4.5	34	20	145

Plastic drinking water hose RAUAQUA®

Plastic drinking water hose

- meets the strict requirements for drinking water hoses
- non-transparency counteracts microbe and algae formation
- wear-resistant and UV resistant

Area of application: Drinking water hose
Reinforcement: Textile lining
Material: PE
Length: 50 m
Norm: DVGW W 270, KTW Cat. „A“
Temperature range: ca. -20 °C to ca. +65 °C
Colour: Core: translucent, Cover: blue



Item No.	Inner diameter mm	Wall thickness mm	Outer diameter mm	Operating pressure bar / 20 °C	€/m
10011199	12.7	3	18.7	20	
10011201	19	3.6	26.2	20	

WATER HOSES

Rubber water hose REIFF WasserFLEX



Rubber water hose for industry and agriculture.

To convey hot and cold water, air and chemical media of low aggressiveness.

- Cover wear and weather-resistant

Area of application:	Water hose
Reinforcement:	Textile lining
Material:	EPDM
Length:	40 m
Temperature range:	ca. -40 °C to ca. +120 °C
Colour:	Core: black, cover: black with 4 red axial stripes

Item No.	Inner diameter mm	Wall thickness mm	Outer diameter mm	Operating pressure bar / 20 °C	Bending radius mm
974290	13	3.5	20	20	100
974300	19	4	27	20	150
974460	25	4.5	34	20	200

Rubber water hose GOLDSCHLANGE®

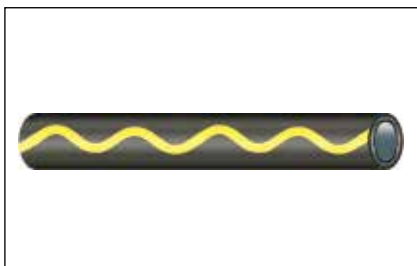

High performance water hose, maximum quality.

- robust, kink-proof and impact resistant
- cover not sensitive to ozone and UV radiation, resistant to oils and greases and for a number of chemicals
- Identification: axial, yellow wavy line on a black background

Area of application:	Water hose
Reinforcement:	Textile lining
Material:	Core: EPDM, cover: CR
Length:	40 m
Temperature range:	ca. -30 °C to ca. +100 °C
Colour:	Core: black, cover: blue with yellow wavy line

Item No.	Inner diameter mm	Wall thickness mm	Outer diameter mm	Operating pressure bar / 20 °C	Bending radius mm
1068130	10	3.6	17.2	30	45
187230	13	3.9	20.8	30	50
1059250	16	3.6	23.2	25	70
187240	19	4.4	27.8	25	80
1068150	22	4.5	31	20	100
187250	25	4.5	34	20	110
729900	32	5.5	43	12	175
1009550	38	6.5	51	12	250
1068170	45	7.5	60	10	290
938940	50	7.5	65	10	300

WATER HOSES



Rubber water hose TRIX-ROTSTRAHL®

Professional rubber water hose with German brand quality.

- highly flexible and robust
- cover: not sensitive to ozone and UV radiation
- Identification: 6 red axial stripes on a black background

Area of application:	Water hose
Reinforcement:	Textile lining
Material:	EPDM
Length:	40 m
Temperature range:	ca. -40 °C to ca. +100 °C
Colour:	Core: black, cover: black with 4 red axial stripes



Item No.	Inner diameter mm	Wall thickness mm	Outer diameter mm	Operating pressure bar / 20 °C	Bending radius mm
187080	13	3	19	20	46
187090	19	4	27	20	65
187100	25	4.5	34	20	110
10025721	32	5.5	43	15	150

Rubber water hose REIFF AquaFLEX

Rubber water hose

- wear-resistant, ageing and weather resistant

Area of application:	Water hose
Reinforcement:	Textile lining
Material:	Core: SBR, cover: SBR/EPDM
Length:	40 m
Temperature range:	ca. -30 °C to ca. +80 °C
Colour:	Core: black, cover: red



Item No.	Inner diameter mm	Wall thickness mm	Outer diameter mm	Operating pressure bar / 20 °C	Bending radius mm
187170	13	3	19	12	80
187180	19	3.5	26	12	110
187190	25	4	33	12	150

WATER HOSES

PVC water hose, yellow

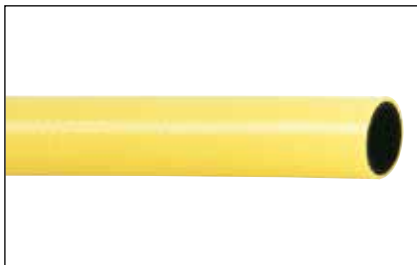

PVC water hose for garden watering.

Area of application: Water hose
Reinforcement: Textile lining
Material: PVC
Temperature range: ca. -15 °C to ca. +60 °C
Colour: Core: black, cover : yellow

Item No.	Inner diameter mm	Wall thickness mm	Outer diameter mm	Length m	Operating pressure bar / 20 °C
191620	12.5	2.25	17	25	10
691180	12.5	2.25	17	50	10
691170	19	3	25	25	10
191670	19	3	25	50	10

Industrial water hose



Industrial water hose for service water, liquid manure and light acids and bases.

Area of application: Industrial hose
Reinforcement: Textile lining
Material: SBR
Temperature range: ca. -30 °C to ca. +80 °C
Colour: black

Item No.	Inner diameter mm	Wall thickness mm	Outer diameter mm	Length m	Operating pressure bar / 20 °C	Bending radius mm
568830	25	5	35	40	10	150
188170	28	5	38	40	10	168
188190	32	5.5	43	40	10	192
188200	35	5.5	46	40	10	210
188210	38	6	50	40	10	228
188220	40	6.5	53	40	10	240
188230	42	6.5	55	40	10	252
188240	45	7	59	40	10	270
188250	50	7	64	40	10	300
188260	60	7	74	40	10	360

WATER HOSES

Cooler hose DIN 73411/79

Cooler hose

- resistant against common frost and corrosion protection
- cover is weather and ozone resistant

Area of application: Cooler hose
Reinforcement: Textile lining
Material: EPDM
Norm: DIN 73411/79
Temperature range: ca. -40°C to ca. +120°C
Colour: black



Item No.	Inner diameter mm	Wall thickness mm	Outer diameter mm	Length m	Operating pressure bar / 20 °C
4500020	8	3.5	15	40	4
4403320	10	3.5	17	40	4
4403330	12	3.5	19	40	4
640880	13	3.5	20	40	4
4403340	15	3.5	22	40	4
4403350	18	3.5	25	40	4
4403360	20	3.5	27	40	4
4107670	22	3.5	29	40	4
4403370	25	3.5	32	40	4
4403380	28	4	36	40	4
4403390	30	4	38	40	4
4403400	32	4	40	40	4
4403410	35	4	43	40	4
4403420	38	5	48	40	4
4403430	40	5	50	40	3
4403440	42	5	52	40	3
4403460	45	5	55	40	3
4403470	48	5	58	40	3
4403480	50	5	60	40	3
4403490	55	5	65	40	3
4403500	60	5	70	40	3
4403510	65	5	75	40	3
4403520	75	5.5	86	40	3
4403530	80	6	92	20	3
4403540	90	6	102	20	2
4403550	100	6	112	20	2
4403560	110	6	122	20	2

WATER HOSES

Cooler hose DBL 6254.11



Cooler hose

- resistant against common frost and corrosion protection
- cover is weather and ozone resistant

Area of application: Cooler hose
Reinforcement: Textile lining
Material: S-EPDM
Norm: DBL 6254.11
Temperature range: ca. -40 °C to ca. +125 °C
Colour: black

Item No.	Inner diameter mm	Wall thickness mm	Outer diameter mm	Length m	Operating pressure bar / 20 °C
836350	10	4.5	19	40	2.5
878770	12	4.5	21	40	2.5
855750	22	4.5	31	40	2.5
4461480	28	4.5	37	40	2.5
870090	32	6	44	40	2.5
1005320	42	6	54	40	2.5
863050	65	6	77	40	2.5
912000	70	6	82	40	2.5

WATER HOSES

Moulded hoses

Ever more complex and narrower installations often make the use of hoses as open length goods impossible. In order to provide you with the right hose for these applications, in the moulded hoses product segment, we work with famous domestic and international producers. We are able to manufacture moulded hoses according to your special needs and requirements in a wide variety of dimensions, materials and designs. Our product spectrum extends from simple moulded hoses of rubber without fabric linings, moulded hoses with knitted linings to wound silicone hoses with multiple Nomex linings. Primarily, our moulded hoses are used by manufacturers of construction vehicles, as cooler and charge air hoses in large kitchens and gastronomic enterprises as feed and drain hoses.

Send us your request with a drawing:
we will immediately submit a free detailed quote.



Washing machine inlet hose

Washing machine inlet hose made of plastic.

Area of application: Washing machine hose
Design: Inlet hose
Reinforcement: Textile lining
Material: Plastic
Length: 40 m
Temperature range: ca. -20°C to ca. +95 °C
Colour: Core: black, cover: grey



Item No.	Inner diameter mm	Wall thickness mm	Outer diameter mm	Operating pressure bar / 20 °C
190450	10	3.5	17	30
190460	13	3.5	20	30

Washing machine drain hose

Washing machine drain hose made of plastic.

Area of application: Washing machine hose
Design: fluted on the outside
Design: Drain hose
Material: Plastic
Length: 40 m
Temperature range: ca. -20°C to ca. +90 °C
Colour: grey



Item No.	Inner diameter mm	Wall thickness mm	Outer diameter mm
190470	19	3.5	26

HOSE CLAMPS

Spiral hose clamp



Special clamp for fastening outer-corrugated spiral hoses of series AIRDUC®, PROTAPE® and TIMBERDUC®.

Also fits CP hoses beginning at 70 mm nominal diameter.

Area of application: Hose clamp

Design: Spiral clamp

Material: W2: Strap and housing: non-rusting steel 1.4016, screw: galvanised steel; bridge: non-rusting steel 1.4301

Item No.	for hose ID	Tension range mm	Belt width mm
4164620	18 - 26	17 - 29	5
4164630	20 - 28	20 - 32	5
4164640	30 - 35	27 - 47	9
4164650	38 - 45	35 - 55	9
4164660	50 - 55	45 - 65	9
4164670	60 - 65	55 - 75	9
4164680	70 - 75	65 - 85	9
4164690	80	75 - 95	9
4164700	90	85 - 105	9
4164710	100 - 102	95 - 115	9
4164720	110 - 115	105 - 125	9
4164730	120 - 127	115 - 135	9
4164740	130	125 - 145	9
4164750	140	135 - 155	9
4164760	150 - 152	145 - 165	9
4164770	160	155 - 175	9
4164780	170 - 175	165 - 185	9
4164790	180	175 - 195	9
4164800	190	185 - 205	9
4164810	200	195 - 215	9
4164820	215	205 - 225	12
4164830	225	215 - 235	12
4164840	250	245 - 265	12
4164850	275	265 - 285	12
4164860	280	275 - 295	12
4164870	300	295 - 315	12
4164880	315 - 325	315 - 355	12
4164890	350	345 - 385	12
4164900	380	375 - 415	12
4164910	400	395 - 435	12
4164920	450	445 - 485	12
4164930	500	495 - 535	12

HOSE CLAMPS



Worm drive clamp NORMACLAMP® TORRO® W1

Area of application: Hose clamp
Design: Worm drive clamps
Design: Norma
Material: W1: completely galvanised steel
Norm: DIN 3017
Type: Torro
Screw: C7



Item No.	Tension range mm	Belt width mm	unit
206580	10 - 16	9	100
206590	12 - 22	9	100
206600	16 - 27	9	100
206620	20 - 32	9	100
206640	25 - 40	9	100
206660	35 - 50	9	50
206680	40 - 60	9	50
206700	50 - 70	9	50
206720	60 - 80	9	25
567040	70 - 90	9	25
1080740	80 - 100	9	25
683440	90 - 110	9	25
837800	16 - 27	12	50
837810	20 - 32	12	50
837820	25 - 40	12	50
1205680	30 - 45	12	50
837830	35 - 50	12	50
837840	40 - 60	12	25
837850	50 - 70	12	25
837860	60 - 80	12	25
837870	70 - 90	12	25
206740	80 - 100	12	25
837890	90 - 110	12	20
837900	100 - 120	12	100
837910	110 - 130	12	100
837920	120 - 140	12	100
837930	130 - 150	12	100
837940	140 - 160	12	100
837950	150 - 170	12	100
837960	160 - 180	12	100
837970	170 - 190	12	50

HOSE CLAMPS



Worm drive clamp NORMACLAMP® TORRO® W5



Area of application: Hose clamp
Design: Worm drive clamps
Design: Norma
Material: W5: completely non-rusting steel 1.4401
Norm: DIN 3017
Type: Torro
Screw: C7

Item No.	Tension range mm	Belt width mm	unit
206910	8 - 16	9	100
206920	12 - 22	9	100
4144970	16 - 27	9	100
206940	20 - 32	9	100
206950	25 - 40	9	100
206960	32 - 50	9	50
206970	40 - 60	9	50
208350	50 - 70	9	50
208360	60 - 80	9	25
10035859	70 - 90	9	25
208720	80 - 100	9	25
413420	90 - 110	9	25
4145020	16 - 27	12	50
206980	20 - 32	12	50
206990	25 - 40	12	50
10013143	35 - 50	12	50
207010	40 - 60	12	25
207020	50 - 70	12	25
207030	60 - 80	12	25
207040	70 - 90	12	25
207050	80 - 100	12	25
207060	90 - 110	12	20
207910	100 - 120	12	100
207450	110 - 130	12	100
207920	120 - 140	12	100
207470	130 - 150	12	100
207940	140 - 160	12	100
207480	150 - 170	12	100
446310	160 - 180	12	100
10035858	170 - 190	12	50

HOSE CLAMPS

Worm drive clamp W1

Area of application: Hose clamp
Design: Worm drive clamps
Material: W1: Strap and housing: Galvanised steel,
 screw: Chromated steel
Norm: DIN 3017



Item No.	Tension range mm	Belt width mm	unit
10018969	8 - 12	9	100
4672110	10 - 16	9	100
4672120	12 - 22	9	100
4672130	16 - 25	9	100
4672150	20 - 32	9	100
4672160	25 - 40	9	100
4672170	35 - 50	9	50
4672180	40 - 60	9	50
4672190	50 - 70	9	50
4690260	60 - 80	9	25
10035832	70 - 90	9	25
10035833	80 - 100	9	25
10003605	90 - 110	9	25
4690200	16 - 25	12	100
4690210	20 - 32	12	100
4690220	25 - 40	12	100
4690230	35 - 50	12	50
4690240	40 - 60	12	50
4690250	50 - 70	12	50
10003607	60 - 80	12	25
10003610	70 - 90	12	25
10003612	80 - 100	12	25
10035835	90 - 110	12	25
10003614	100 - 120	12	25
10035836	110 - 130	12	25
10035837	120 - 140	12	25
10035838	130 - 150	12	25
10035839	160 - 180	12	25

HOSE CLAMPS

Worm drive clamp W5



Area of application: Hose clamp
Design: Worm drive clamps
Material: W5: Strap, housing and screw: non-rusting steel 1.4401
Norm: DIN 3017

Item No.	Tension range mm	Belt width mm	unit	
10005496	10 - 16	9	100	
10005497	12 - 22	9	100	
10005504	20 - 32	9	100	
10005505	25 - 40	9	100	
10005506	35 - 50	9	50	
10033937	40 - 60	9	50	
10005487	50 - 70	9	50	
10033940	60 - 80	9	25	
10005490	70 - 90	9	25	
10033941	80 - 100	9	25	
10033942	90 - 110	9	25	
10033944	16 - 25	12	100	
10005467	20 - 32	12	100	
10005472	25 - 40	12	100	
10005475	35 - 50	12	50	
10005478	40 - 60	12	50	
10033945	50 - 70	12	50	
10033948	60 - 80	12	25	
10005492	70 - 90	12	25	
10033950	80 - 100	12	25	
10005494	90 - 110	12	25	
10033953	110 - 130	12	25	

HOSE CLAMPS



Worm drive clamp IDEAL®

Area of application: Hose clamp
Design: Worm drive clamps
Design: Ideal
Material: W1: completely galvanised steel
Norm: DIN 3017



Item No.	Tension range mm	Belt width mm	unit	€/100 units
208480	8 - 12	9	100	
208490	10 - 16	9	100	
208500	12 - 20	9	100	
208520	16 - 25	9	100	
208540	20 - 32	9	100	
208560	25 - 40	9	100	
208580	32 - 50	9	50	
208600	40 - 60	9	50	
567700	50 - 70	9	50	
680760	60 - 80	9	50	
413260	70 - 90	9	50	
1072390	80 - 100	9	loose	
1084560	90 - 110	9	loose	
1085890	100 - 120	9	loose	
208510	12 - 20	12	100	
208530	16 - 25	12	100	
208550	20 - 32	12	100	
208570	25 - 40	12	100	
1086120	30 - 45	12	50	
208590	32 - 50	12	50	
208610	40 - 60	12	50	
208620	50 - 70	12	50	
208630	60 - 80	12	50	
413270	70 - 90	12	50	
635000	80 - 100	12	loose	
428780	90 - 110	12	loose	
635010	100 - 120	12	loose	
430600	110 - 130	12	loose	
208370	120 - 140	12	loose	
635020	130 - 150	12	loose	
603820	140 - 160	12	loose	
635030	150 - 170	12	loose	
208730	160 - 180	12	loose	
635040	170 - 190	12	loose	
635050	180 - 200	12	loose	
635060	190 - 210	12	loose	
635070	200 - 220	12	loose	
635080	210 - 230	12	loose	
635090	220 - 240	12	loose	
635100	230 - 250	12	loose	

HOSE CLAMPS



Worm drive clamp IDEAL® MAXI



Area of application: Hose clamp
Design: Worm drive clamps
Design: Ideal Maxi
Material: W1: completely galvanised steel

Item No.	Tension range mm	Belt width mm	unit	€/100 units
208640	60 - 80	20	loose	
208650	70 - 90	20	loose	
208660	90 - 120	20	loose	
208670	105 - 130	20	loose	
208680	122 - 157	20	loose	
208690	142 - 177	20	loose	
208700	167 - 202	20	loose	
208710	192 - 227	20	loose	
1027970	217 - 252	20	loose	
413280	242 - 277	20	loose	
1086030	267 - 302	20	loose	
413290	292 - 327	20	loose	

HOSE CLAMPS



T-bolt-clamp NORMACLAMP® GBS M

Area of application: Hose clamp
Design: T-bolt-clamp
Design: Norma
Material: W2: Strap: non-rusting steel 1.4510/1.4511, clamp head parts: Galvanised steel
Type: GBS M
Screw: SK



Item No.	Tension range mm	Belt width mm	unit	€/100 units
1080570	17 - 19	18	50	
1067520	19 - 21	18	50	
4163440	21 - 23	18	50	
1049180	23 - 25	18	50	
4072550	25 - 27	18	50	
1049090	27 - 29	18	50	
1049100	29 - 31	18	50	
1049110	31 - 34	18	50	
4163450	34 - 37	18	50	
1049130	37 - 40	18	50	
1049140	40 - 43	18	50	
1049150	43 - 47	20	50	
1049160	47 - 51	20	50	
1049170	51 - 55	20	50	
1015390	55 - 59	20	50	
1049190	59 - 63	20	50	
1049200	63 - 68	20	50	
1049210	68 - 73	25	25	
818250	73 - 79	25	25	
816270	79 - 85	25	25	
1049240	85 - 91	25	25	
1049260	91 - 97	25	25	
1049270	97 - 104	25	25	
1049280	104 - 112	25	25	
1049220	112 - 121	25	25	
1049230	121 - 130	25	25	
907550	130 - 140	30	10	
1049540	140 - 150	30	10	
1163700	150 - 162	30	10	
4163460	162 - 174	30	10	
1049630	174 - 187	30	10	
1049640	187 - 200	30	10	

HOSE CLAMPS

2-lug hose clamp



Area of application: Hose clamp
Design: 2-ear clamp
Material: Galvanised steel

Item No.	Tension range mm	unit	€/ 100 units
208870	5 - 7	2.000	
208880	7 - 9	1.000	
208890	9 - 11	1.000	
208900	11 - 13	500	
208910	13 - 15	500	
450200	14 - 17	500	
208920	15 - 18	500	
208930	17 - 20	250	
464750	18 - 21	250	
208940	20 - 23	250	
464760	22 - 25	200	
208950	23 - 27	200	
464770	25 - 28	200	
208960	28 - 31	100	
208970	31 - 34	100	
208980	34 - 37	100	
208990	37 - 40	100	
209000	40 - 43	75	
209010	43 - 46	75	

HOSE CLAMPS



In addition to the TORRO® and GBS clamps, we also provide other NORMA clamps as part of our offering.

NORMACLAMP® S hose clamps with jaw tightening

NORMACLAMP® S is a hose clamp with jaw tightening according to DIN 3017. It is suitable for fastening rubber and plastic hoses and rubber collars onto pipe ends or hose nozzles.

In extremely high tensile and pressure loads, the two-part variation is recommended.

- Tension range: 6 to 120 mm
- Strap width: 7 to 20 mm
- Material: W1: All parts completely galvanised steel



NORMACLAMP® COBRA screwless hose clamp

NORMACLAMP® COBRA is a screwless, one-part hose clamp. Its low design height enables precise installation in narrow spaces. The NORMACLAMP® COBRA is fast and easy to install.

- Tension range: 7.5 to 30 mm
- Belt widths: 7 and 8 mm
- Material: W4: All parts are completely non-rusting steel 1.4301



NORMAFIX® RSGU pipe support clamp

NORMAFIX® RSGU pipe support clamps according to DIN 3016 are suitable for fastening pipes, cables, cable trunks, cable conduit, hoses and other lines.

- tension range: 6 to 40 mm
- belt widths: 12 to 20 mm
- material: W1: All parts completely galvanised steel



NORMAFIX® BSL fastening clamp

With the NORMAFIX® BSL fastening clamps according to DIN 72571 (single-lug) or DIN 72573 (dual lug) pipes, cable or cable conduit can be quickly and easily installed onto structures. They are suitable for all industrial areas in which cost effective and safe installation is required.

- Belt widths: 10 and 12 mm
- For 1 to 6 lines
- Material: W1: All parts completely galvanised steel



NORMACLAMP® TORRO® accessories

Flexible screwdrivers with exchangeable nut SW 6/SW 7.

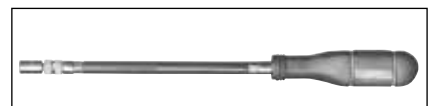

HOSE CLAMPS

BANDIMEX® strip

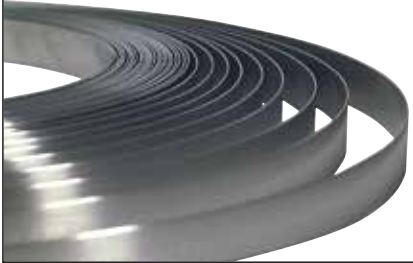

Strip with fully rounded edges for the Bandimex fastening system.
For use with Bandimex slings of the same width.

Area of application: Fastening system
Design: Strip
Design: Bandimex
Material: Rust-proof steel V2A

Item No.	Belt width mm	Belt thickness mm	m
209040	6.4	0.50	30
209050	9.5	0.64	30
209060	12.7	0.75	30
209070	16	0.75	30
209080	19	0.75	30

BANDIMEX® slings



Slings for the Bandimex fastening system.
For use with single or dual slung Bandimex strips of the same width.

Area of application: Fastening system
Design: Sling
Design: Bandimex
Material: Rust-proof steel V2A

Item No.	Belt width mm	unit
209130	6.4	100
209140	9.5	100
209150	12.7	100
209160	16	100
209170	19	100

REIFF CAN DO MORE

With a product range of more than 140,000 standard products, it is impossible to know every product. Antifriction bearings, V-belts, hydraulic hoses or sealing rings – the products are as diverse as the intended applications and application areas themselves.

Explore our diverse product areas and discover the possibilities this catalogue provides.

From the standard product to the special design –
we are true product specialists in the areas of:

DRIVE TECHNOLOGY

FLAT SEALS, RUBBER COMPONENTS AND INSULATORS
RUBBER AND PLASTIC PROFILES

LINEAR TECHNOLOGY

VIBRATION DAMPING ELEMENTS

SEALING ELEMENTS ANTIFRICTION BEARINGS

SEALING TECHNOLOGY

ADHESIVES, SEALANTS AND LUBRICANTS
HYDRAULIC HOSES AND FITTINGS

HOSE TECHNOLOGY

INDUSTRIAL HOSES AND FITTINGS
V-BELTS, FLAT BELTS, CONVEYOR BELTS

PROFILE TECHNOLOGY

PLASTICS
HYDRAULIC / PNEUMATIC SEALS
TIMING BELTS AND PULLEYS

If required, we are also pleased to
assemble different product elements into
individual assemblies.

